

# ROCKVILLE

## WET-7020 70V IP55 COMMERCIAL INDOOR/OUTDOOR SPEAKER

### OWNER'S MANUAL

**ATTENTION:  
WATCH THIS VIDEO BEFORE USE!**

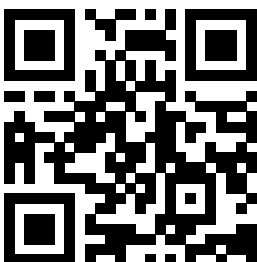

### ***Who reads manuals?***

Instead, go to [vimeo.com/461124525](https://vimeo.com/461124525) or scan the QR code and watch a short video, which shows you how to set this item up and how to use it.

**If you like to read though, we won't stop you LOL!**

*Isn't it good to have options? With Rockville we offer options.*

**Missing items?** If you ordered a bundle that includes more than one product and you are missing part of your bundle then it just means your order shipped from two different warehouses. You will receive the remaining items very soon. If you have any concerns or inquiries, feel free to call our customer support center at 646-758-0144, Monday through Thursday, 9am to 10pm EST, and Fridays, 9am to 3pm EST.

רשת  
רוכב

Thank you for purchasing this Rockville product. Please read this owner's manual carefully for proper use of your Rockville WE-7020 70V Commercial Wall Mount Speakers. Should you need assistance, please call our technical help line at 1-646-758-0144, Monday through Thursday, 9am to 10pm EST., and Fridays, 9am to 3pm EST.

## IMPORTANT SAFETY INSTRUCTIONS



**TO REDUCE THE RISK OF ELECTRICAL SHOCK, NEVER OPEN THE UNIT. NO USER SERVICEABLE PARTS INSIDE. WE RECOMMEND TAKING THE UNIT TO A QUALIFIED SERVICE TECHNICIAN FOR ANY REPAIRS.**

- Always mount this unit in a safe and stable manner. Ensure that the mounting surface is structurally sound and can support the weight of the speaker.
- When mounting the speaker, do not use nails, adhesives, or other inappropriate devices. Long-term use and vibrations may cause it to fall easily.

## What is 70 Volt?

70-volt systems are the number one choice for any application where you want to install multiple speakers. With 70 volt there are a lot of advantages over 8-ohm systems. One of the main advantages is the simplicity of the wiring as well as how easy it is to match up the speakers with an amplifier. You always want your 70-volt amp to have at least 15 or 20% more power than the combined watts your speakers are tapped at. For example, if you have a 180-watt/70-volt amplifier, you can install ten 70-volt speakers that are tapped at 15 watts each or twenty-five 70-volt speakers that are tapped at 5 watts each as long as they total close to 150 watts. When we say the word tap, what we are referring to is the selector knob at the rear of the WET-7020 speakers. It allows you to set how many watts the built-in transformer will allow the speaker to get from the amplifier. These speakers have taps set at 2.5, 5, 10, and 20 watts. This range of taps allows for full customization of the sound for the space in which the speakers are installed. In a restaurant, for example, you can tap your dining room speakers at 5 watts, the speakers in the outside seating area at 20 watts, the ones in the hallway at 2.5 watts, and the speakers in the bathrooms at 5 watts. Another great feature of 70-volt speakers is that you can mix and match any type whether they are wall mounted speakers (such as these), ceiling speakers, subwoofers, etc.

Another benefit of 70-volt speaker set-ups is the ability to run very long lines of speaker wire without signal loss. And, the wiring is very simple. You just connect all the positive terminals of the speakers to the positive 70-volt terminal(s) of the amplifier. The negative terminals on the speaker get connected to the negative (COM) terminal(s) of the amp. You do not have to worry about impedance as the power is constant.

Please be sure to check out Rockville's complete selection of high-quality, 70-volt speakers, amplifiers, and accessories.

## Parts

1. Rustproof/Waterproof Aluminum Grill
2. 13mm PEI Tweeter
3. Bracket Screw (left and right)
4. 5.25" Woofer with Polypropylene Cone
5. 4-Way Swivel Mounting Bracket
6. 70V/8-Ohm Tap Switch
7. Water-proof Spring Loaded Terminals

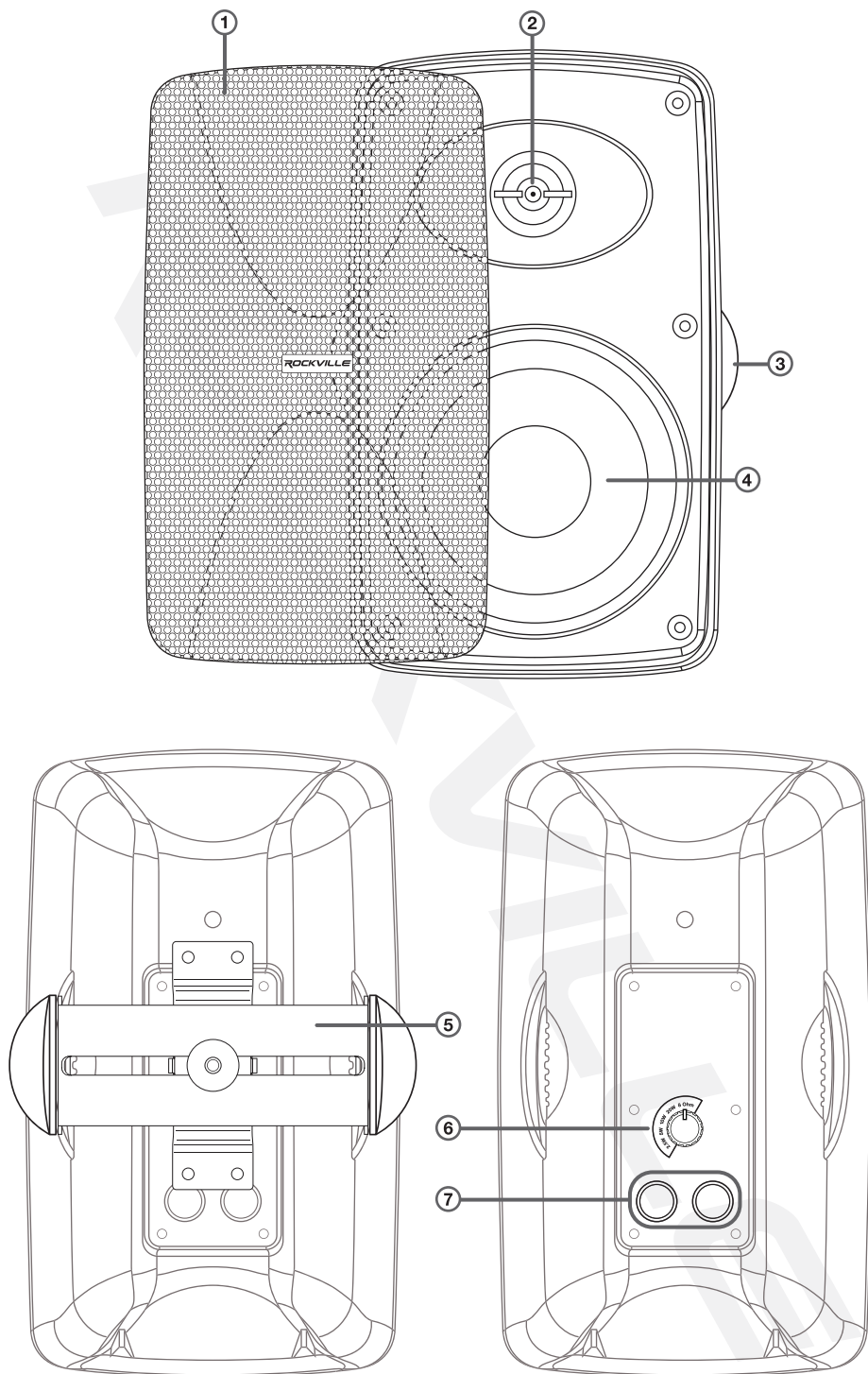

## Removing/Attaching the Grill

To remove the grill, carefully grip the sides of the grill and gently pull it away from the speaker (fig a). To attach the grill, simply align the edges with the inner groove on the front of the speaker and press gently until the grill is securely seated in place (fig b).

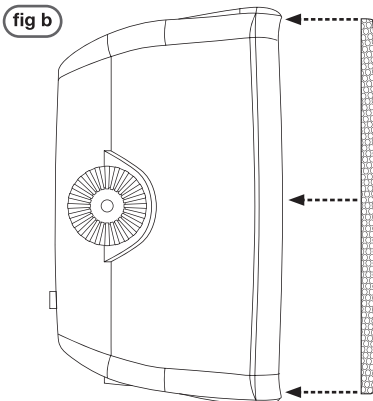
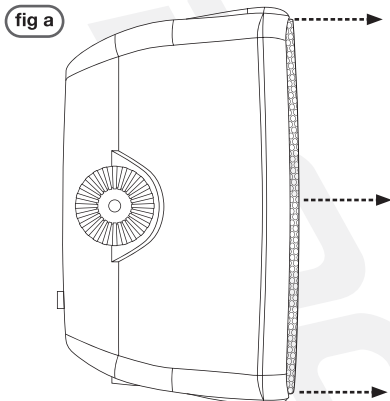

## Mounting

These speakers can be mounted horizontally (figure c) or vertically (figure d) and can be installed on a variety of surfaces. When mounting horizontally, make sure to place the mounting bracket at a height that will allow the front of the speaker to be tilted towards the listening area.

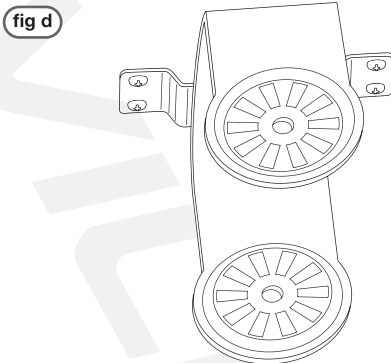
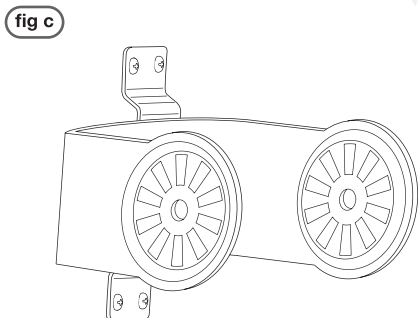

## Drywall Installation

1. Using the mounting bracket as a template, mark the mounting screw locations. We recommend you use a stud finder to locate the wall studs and mark their location.
2. Drill pilot holes for the screws. If you are installing between studs we recommend using anchors. Be sure to use the proper drill bit size for the anchors. Use no less than 2 anchors to secure the mounting bracket.
3. Now screw the bracket in place. Be sure that the screws are properly seated and that the bracket is securely mounted.

## Masonry Installation

1. Mark the location of the mounting screws using the mounting bracket as a template.
2. Use a masonry drill bit to make pilot holes for the anchors.
3. Insert the anchors and attach the mounting bracket using the appropriate screws.

## Exterior Installation

1. Hold the bracket up to the mounting surface. Use a level to ensure that the bracket is square with its surroundings. Now mark the location of the mounting screws.
2. Drill pilot holes for the screws. If you are installing on an exterior wall with siding, make sure the screws are long enough to penetrate the siding and the surface behind it. For exterior walls, we recommend you apply a ring of caulk or sealant around each hole.
3. Now screw the bracket in place. Be sure that the screws are properly seated and that the bracket is securely mounted.

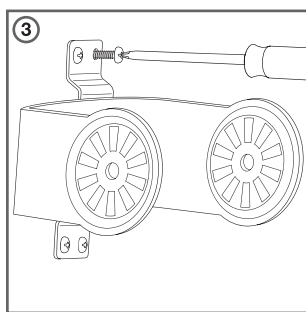
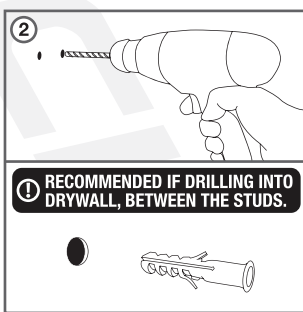
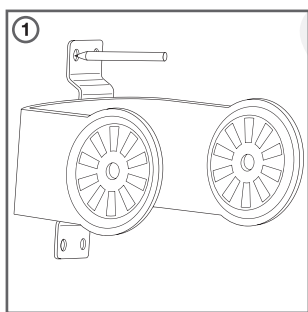

## Adjusting the Angle of the Speaker Bracket.

Loosen the hex nut securing the speaker bracket to the mounting bracket (figure e). Move the speaker left or right to the desired position and tighten the hex nut to lock the bracket in place (figure f).

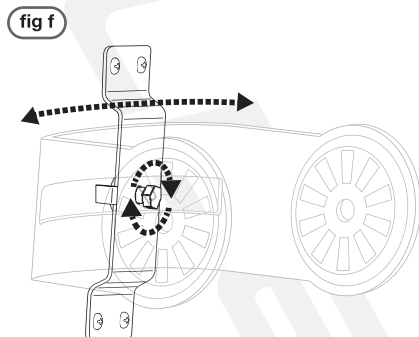
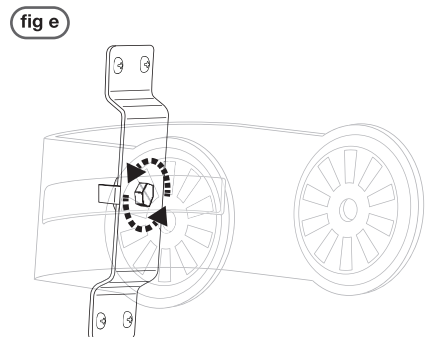

# Attaching the Speaker to the Mounting Bracket

Begin by sliding the bracket onto the speaker (figure g). Use the lock knobs to secure the bracket onto speaker, but do not tighten completely (figure h). Adjust the angle of the speaker and fully tighten the knobs (figure i).

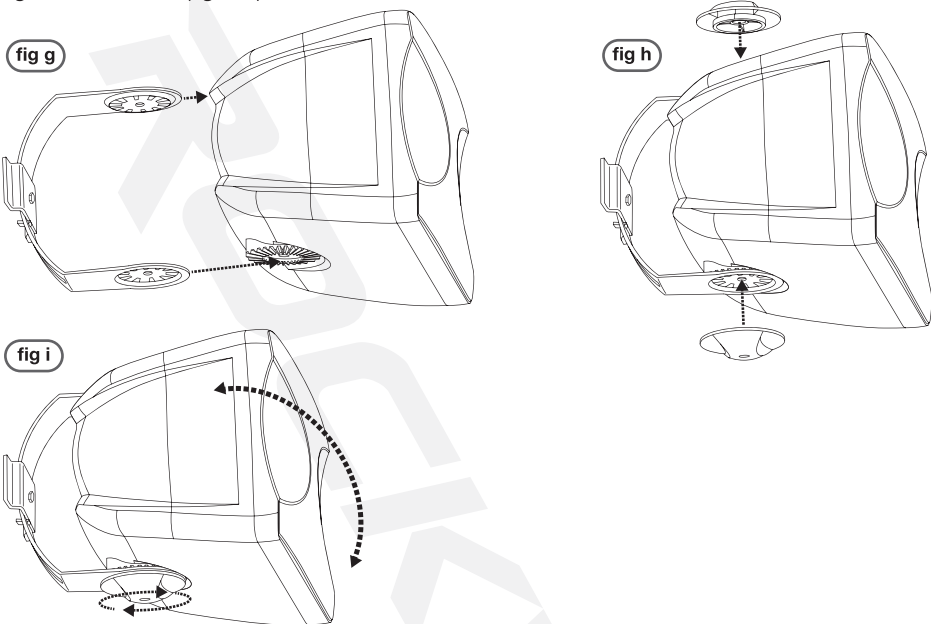

## Setup

### 70V Speaker Configuration

The total number of speakers multiplied by the tap value cannot exceed the output power (in watts) of your 70V amplifier. The example below shows 5 total speakers. Using the 20W taps, you will need an amplifier with at least 100 watts ( $5 \times 20 = 100\text{W}$ ). A good rule of thumb is to select an amplifier with 15 to 20% greater power; in this case, an amplifier that delivers about 120W.

5 SPEAKERS CONNECTED IN PARALLEL USING 20W TAPS

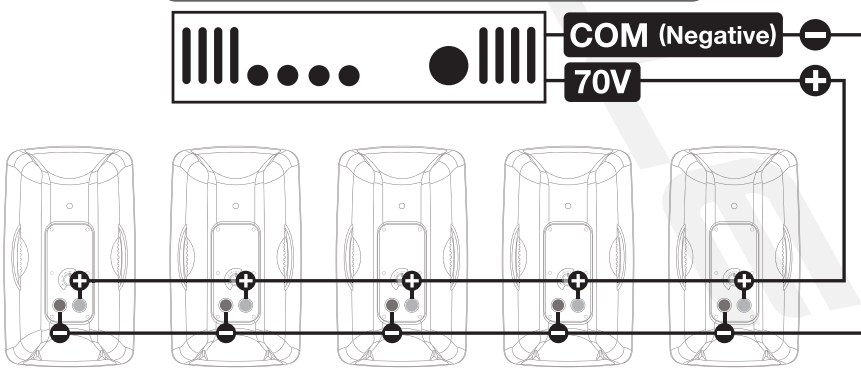



## 8-Ohm Speaker Configuration

2 SPEAKERS CONNECTED TO AMPLIFIER WITH 8-OHM OUTPUT

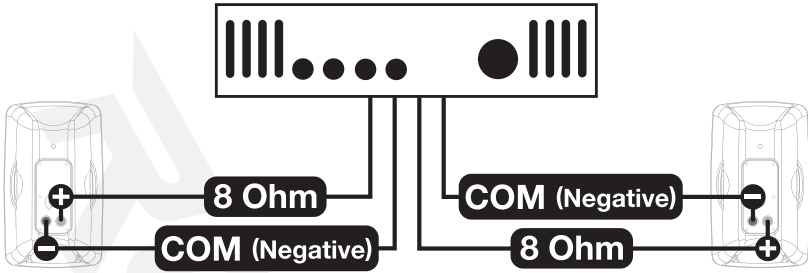

**! Please note:** be sure to set the tap to 8 ohm.

## Features and Specifications

- IP55\* rating makes this perfect for outdoor use or indoor use
- 4-Way swivel bracket allows angle adjustments up, down, left, and right
- Weather resistant
- Rugged waterproof speaker enclosure
- Aluminum grill is waterproof and rustproof
- Waterproof spring-loaded terminals
- Built-in transformer supports 70V installations
- Built-in tap switch with 2.5W, 5W, 10W, and 20W power settings
- 5.25" Woofer with Polypropylene cone
- 13mm PEI tweeter is very efficient and has great sound
- Frequency Response: 68Hz – 20Khz
- Sensitivity: 85dB
- RMS Power: 30W (when using 8 ohm)
- Nominal impedance: 8 Ohm
- Color: White or Black
- Weight: 4.16 Lbs each
- Cabinet dimensions: 9.44" x 5.7" x 6.17"

\*Can withstand jet streams spraying it from any angle without any damage

# Troubleshooting

PROBLEM	SOLUTION
No sound/ distorted sound	<ol style="list-style-type: none"><li>1. Check all connections.</li><li>2. Check that the tap is properly set.</li><li>3. Check the volume/levels settings of your amplifier.</li><li>4. If volume and treble/bass settings are maxed out, turn one of them down.</li><li>5. Check volume and gain settings on all input sources.</li><li>6. If using a mixing console make sure the fader and balance are set to center positions and levels are increased. Make sure the mixer is plugged into the correct input.</li></ol>

מכירת רכב

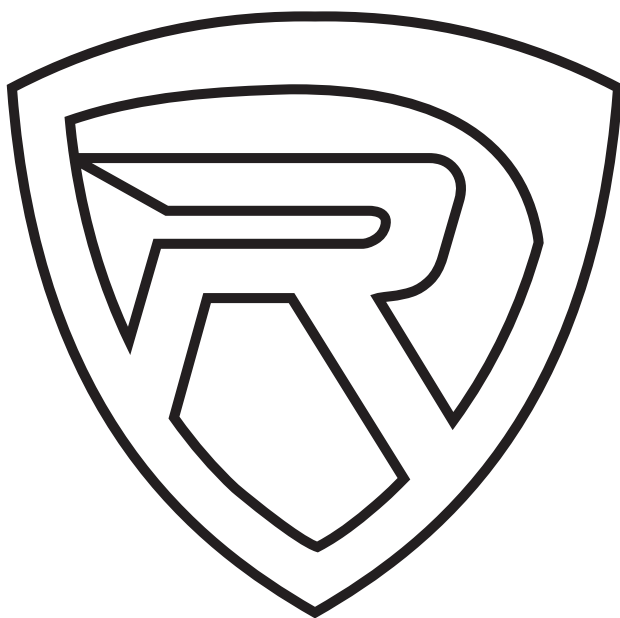

**RockvilleAudio.com**

© 2021 ROCKVILLE // Features and specifications are subject to change and or improvement without notice.