



Thank you for purchasing this Rockville VOL85 Series Wall Volume Controller. Please read this owner's manual carefully for proper use. Should you need technical assistance, please call our help line at 1-646-758-0144, Monday through Thursday, 9am to 10pm EST, and Fridays, 9am to 3pm EST.

The VOL850 and VOL855 are wall mounted volume controllers that work with any standard home audio or pro audio system that operates with 4-8 ohm speakers. Our volume controllers are some of the best on the market. The reliability and accuracy is what makes a big difference. These 12 step controllers are precise and accurate. They support speakers connected to them that add up to 50 watts RMS or less. If you already have a multi-zone amplifier then you can go out from any zone and into this volume controller and then out from the controller into the speakers (each speaker is wired from one to the next in parallel). The end result is that you can access the volume control from that room without having to change the volume from the amplifier itself.

### FEATURES AND SPECIFICATIONS VOL850

- This works with standard 8 ohm audio systems
- Perfect for systems that have multi room playback
- Allows you to control up to 4 speakers that add up to 50 watts
- Rotating volume control with 12 step attenuation and absolute off
- White single gang plate fits standard single gang electrical boxes
- Rugged ABS Frame
- Special tape protects the internal board from dust
- Mounting screws are included
- 16 – 24 AWG wire inputs
- Total Attenuation: 30dB
- Frequency Response: 20Hz – 20 kHz
- Color: White
- Installation depth: 2.44" inches
- Dimensions: 2.75" x 4.4" x 3.26"
- Item Weight: 0.77 Lbs

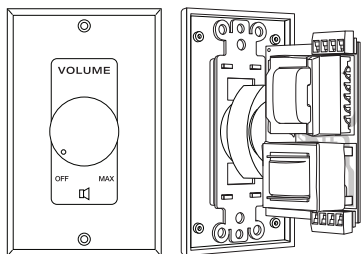

### INSTALLATION

- It is recommended that these volume controls be mounted in a "backless" junction box so they get adequate ventilation. If an enclosed box is to be used, we recommend a deep box (3.5 inches in depth).
- Do not overtighten the VOL855 mounting screws as this may cause the slider to not move smoothly.
- For safety reasons, all controls will be set to OFF out of the box. This is to ensure that no current passes through the switch during installation.

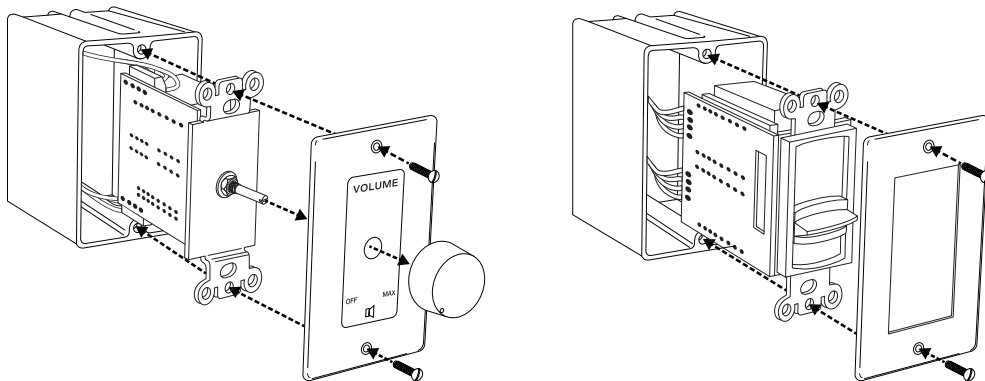

### FEATURES AND SPECIFICATIONS VOL855

- This works with standard 8 ohm audio systems
- Perfect for systems that have multi room playback
- Allows you to control up to 4 speakers that add up to 50 watts
- Impedance matching switch
- Sliding volume control with 12 step attenuation and absolute off
- White single gang plate fits standard single gang electrical boxes
- Rugged ABS Frame
- Special tape protects the internal board from dust
- Mounting screws are included
- 16 – 24 AWG wire inputs
- Total Attenuation: 30dB
- Frequency Response: 20Hz – 20 kHz
- Color: White
- Installation depth: 2.44" inches
- Dimensions: 2.75" x 4.4" x 3.26"
- Item Weight: 0.77 Lbs

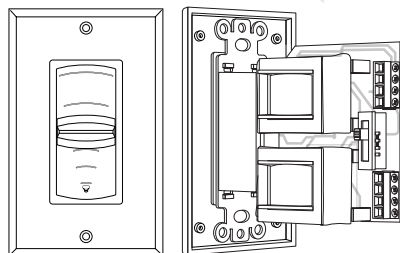

### WIRING VOL850

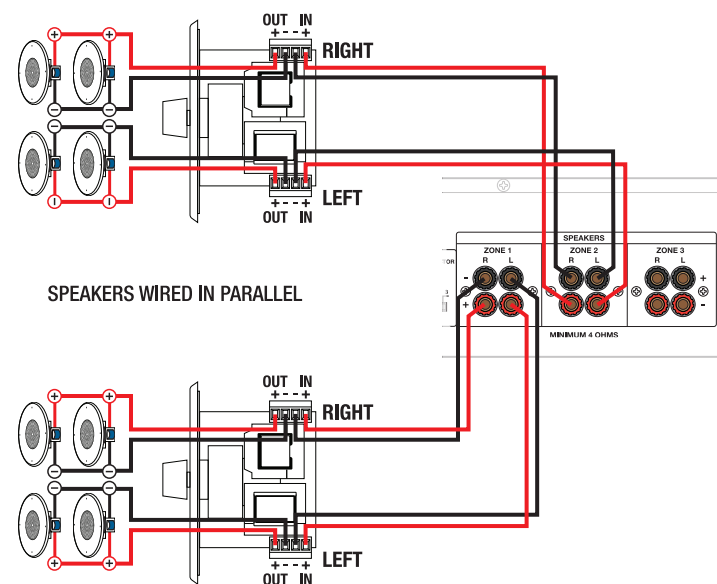

### VOL855

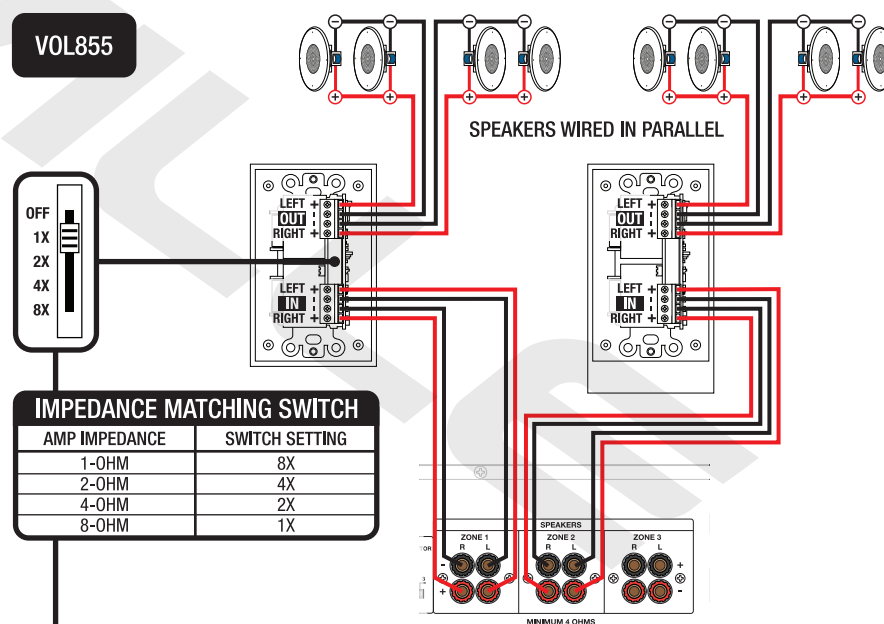

### IMPEDANCE MATCHING SWITCH

AMP IMPEDANCE	SWITCH SETTING
1-OHM	8X
2-OHM	4X
4-OHM	2X
8-OHM	1X

The VOL855 features an impedance matching switch which will allow to match your amp's minimum impedance, regardless of the number of speakers you use and their final impedance. For example, if your amplifier has a minimum impedance of 4 ohms and your speaker's final impedance is 2 ohms, the impedance switch should be set to 2X.