

SINGMIX SERIES
PROFESSIONAL KARAOKE RECEIVER

רוסנקרן

Thank you for purchasing this SINGMIX series Professional Karaoke Receiver. Please read this guide carefully for proper use of your Rockville SINGMIX series Professional Karaoke Receiver. Should you need technical assistance, please call our technical help line at 1-646-758-0144, Monday through Friday, 9am to 5pm EST.

INCLUDED

- SINGMIX receiver
- Removable rack ears
- Remote control
- (2) L/R banana to male Speakon cables
- Screwdriver
- Manual
- Warranty card

IMPORTANT SAFETY INSTRUCTIONS

- To reduce risk of shock, never open the unit. There are no user serviceable parts. For service, return the unit to Rockville or take it to an authorized service center.
- Do not expose this unit to any kind of moisture.
- Do not place this unit near heat sources or expose to direct sunlight.
- Do not place anything on top of the unit. Doing so will block vents and cause the unit to overheat.
- Please ensure that the unit is situated in a properly ventilated area.

INPUTS/OUTPUTS

- Front: (3) 1/4" mic inputs
- Front: USB/SD Inputs
- Rear: (4) RCA Inputs
- Rear: (4) RCA video inputs
- (2) RCA outputs (line and record -- can connect a powered sub or another amp and recording device)
- (2) RCA video outputs

FUNCTIONS

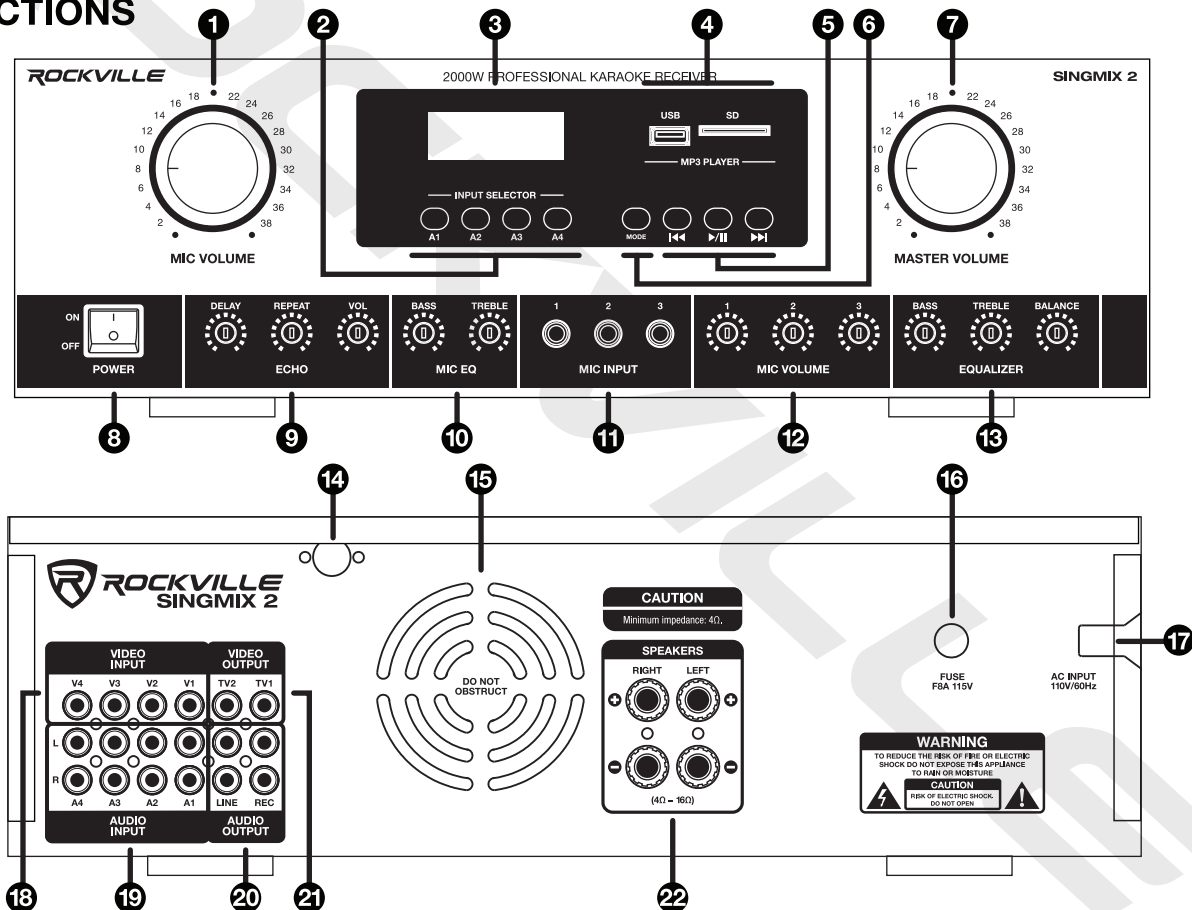

1. Microphone volume control
2. Input selectors
3. LCD display
4. USB/SD input ports
5. Play/Pause: press once to play current track, press again to pause.
Previous|Vol -/Next|Vol+ controls: Long press to lower/raise MP3 playback volume. Short press to return to previous track or proceed to the next track.
6. Mode: Bluetooth, USB, SD, and FM
7. Master volume
8. Power switch
9. Mic Echo: delay, repeat, volume
10. Mic EQ
11. ¼" Mic inputs
12. Mic volume
13. Equalizer
14. FM antenna
15. Exhaust fan
16. User serviceable fuse
17. 110V power input
18. RCA Video inputs
19. RCA Audio inputs
20. RCA Audio outputs
21. RCA Video outputs
22. Binding post/Banana speaker outputs

BLUETOOTH

Pairing

1. Turn on the Bluetooth feature on your device and ensure that it is in "discoverable" mode.
2. Press the Mode key until the display screen reads "bBLUE". The word will flash indicating the unit is in pairing mode.
3. Once in Bluetooth mode, look for "SINGMIX" on your device and select it.
4. If pairing is successful you will hear a tone and the word "bBLUE" will stop flashing.

Please note that the unit will remember the last paired device.

Playback

1. Play/Pause: press once to play current track, press again to pause. Previous|Vol -/Next|Vol+ controls: Long press to lower/raise Bluetooth playback volume. Short press to return to previous track or proceed to the next track.
2. Playback may also be controlled from your Bluetooth device.

USB/SD

1. Insert a USB drive or SD card into the corresponding port on the front panel.
 2. The unit will automatically begin to play music stored on the external device.
 3. Play/Pause: press once to play current track, press again to pause. Previous|Vol -/Next|Vol+ controls: Long press to lower/raise MP3 playback volume. Short press to return to previous track or proceed to the next track.
- Please note, inserting a USB drive or an SD card will override FM radio mode and Bluetooth mode.

FM RADIO

1. Press the Mode key until you enter FM radio mode.
2. Long press the Play/Pause on the remote control to initiate auto scan. The unit will automatically search and store stations.
3. Short press Previous/Next buttons on the remote control to navigate through preset stations.
4. Short press Previous/Next buttons to manually tune stations.
5. Long press Previous/Next buttons to scan to previous/next available station with good reception.

SET-UP

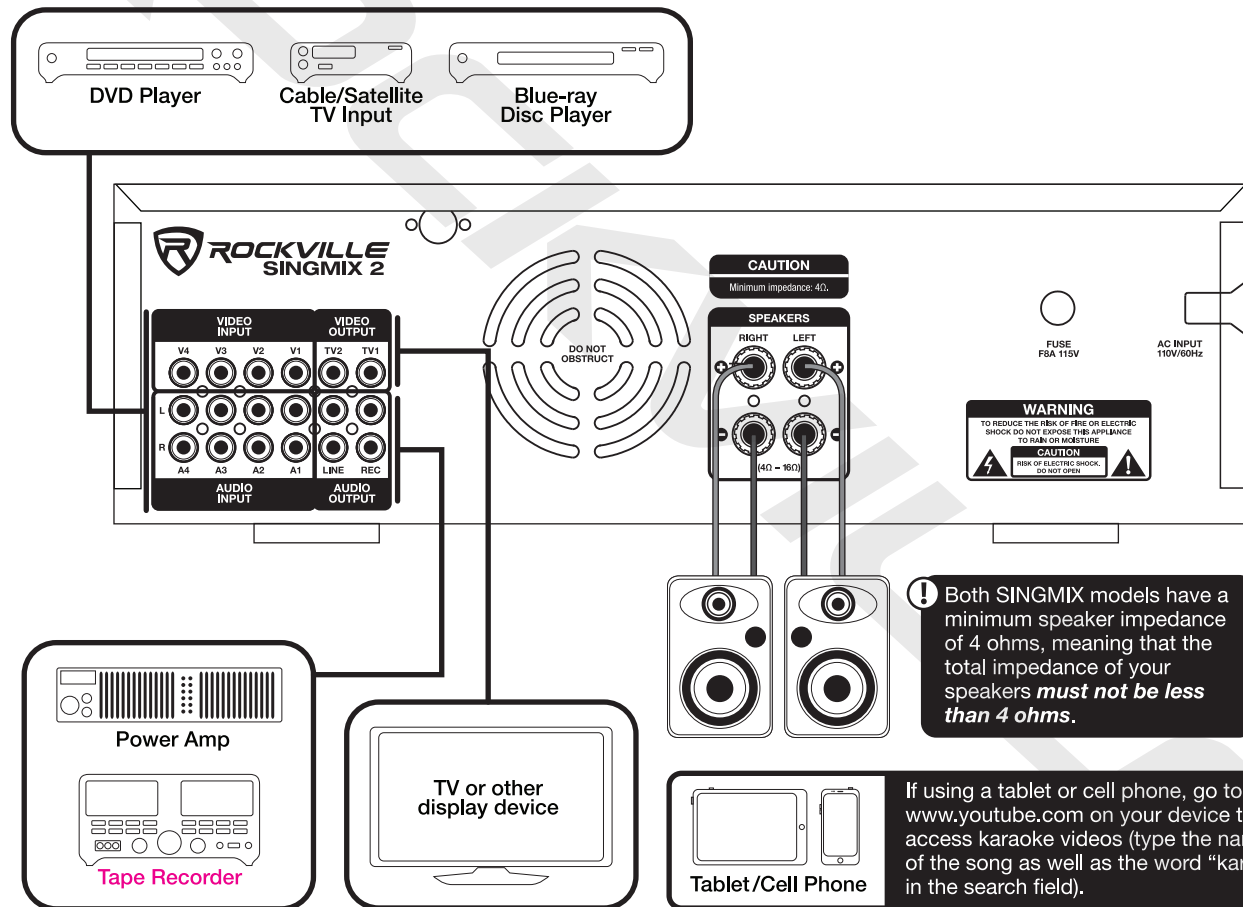

CHOOSING COMPATIBLE SPEAKERS

Speaker Types

Full Range Speakers: These are speakers that can produce a full range of sound. They usually come in a 2-way configuration (woofer and tweeter) or a 3-way configuration (woofer, tweeter, and mid range driver). They can vary in size from 6.5" to 15". The quantity and type will be determined by the size of the room and the specific requirements of your karaoke set-up. We recommend our KPS or SPGN series of speakers which can be found at RockvilleAudio.com. For the SINGMIX 2 it is suggested you use the 6", 8", or 10" models. For the SINGMIX 3 we suggest using the 10" or 12" models.

Matching Power Output: When determining a speaker's power handling capability it's best to use "RMS" ratings. This is the continuous amount of power (in watts) that the speaker can handle. You will want an amplifier whose output is the same or higher than the RMS power rating of the speaker. Example: if your speaker has an RMS rating of 300 watts then the amplifier minimum output should be at least 600 watts. If you are using stereo speakers, rated at 300 watts RMS each, the amp should have an output of at least 600 watts per channel.

Matching Impedance: It's important that you match the impedance of your speakers to your amplifier. Both SINGMIX models have a minimum speaker impedance of 4 ohms, hence the total impedance of your speakers ***must not be less than 4 ohms***.

SPEAKER CONFIGURATIONS

1. One 4 ohm speaker attached to each channel.

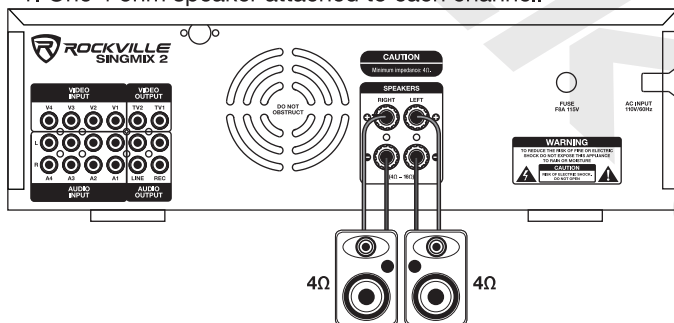

2. One 8 ohm speaker attached to each channel.

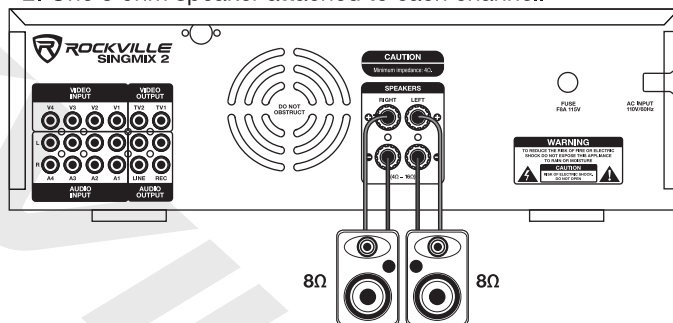

3. Two 8 ohm speakers, in parallel, attached to each channel.

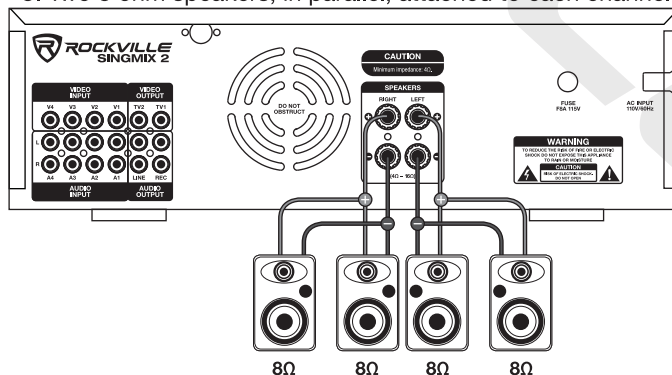

MIC CONNECTIONS, ECHO, MIC EQ, and EQ

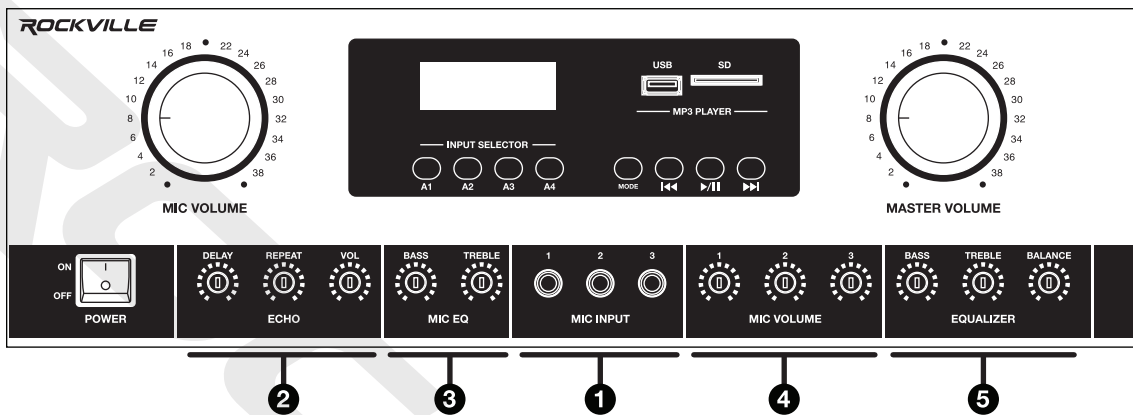

1. Connect wired mics (not included) to any one of the three 1/4" mic jacks located at the front of the unit.
2. **Echo:** The echo effect adds a series of repeated, decaying echoes to a sound. Equalizing the delays, will change a room's sound characteristics from one that has reflective surfaces (brighter sounding echoes) to one that is totally absorptive (darker sounding echoes).
 - Delay: Specifies the number of milliseconds, beats, or samples between each echo. Example: a setting of 100 milliseconds would result in a 1/10th of a second delay between successive echoes.
 - Repeat: Determines how often the echo will be repeated.
 - Volume: Sets the sound level of the echo effect.
3. **Mic EQ:** The mic EQ section allows you to independently control the bass and treble levels of all mic input.
4. **Mic Volume:** Dedicated independent mic volume controls allow you to control the output level of each mic.
5. **Equalizer:** The the bass and treble controls allow the user to make adjustments to these settings which will affect overall sound output. The balance control equalizes the output levels at your listening position even when its not centered between the two main channels. Since rooms are not always symmetrical and furniture placement dictates the position of the speaker system, it is not always possible to arrange for the listening position to be centered exactly between the two main channels. Use the balance control to correct the offset which will restore the stereo image dramatically.

USING YOUR BLUETOOTH ENABLED DEVICE FOR KARAOKE

1. Decide which device you would like to use as your karaoke viewing screen (iPad, iPhone, Android, tablet, or Laptop. We recommend using the Rockville IPS20 Tablet/SmartPhone/iPhone/iPad Tripod Stand. It can be found at RockvilleAudio.com)
2. Turn on your device and the SINGMIX unit. Pair the two using the Bluetooth feature (follow the pairing procedures on page 4).
3. Next go to www.youtube.com on your device and type the name of the song you would like to sing (+ the word karaoke) into the YouTube search field.
9. Adjust the volume of the SINGMIX and microphones as you see fit. Now you're ready to sing!

FEATURES

- **SINGMIX 2:** 2000 Watts peak output/**SINGMIX 3:** 3000 Watts peak output
- **4 Ohm:** **SINGMIX 2:** 500 Watts RMS (250 x 2)/**SINGMIX 3:** 750 Watts RMS (375 x 2)
- **8 Ohm:** **SINGMIX 2:** 350 Watts RMS (175 x 2)/**SINGMIX 3:** 525 Watts RMS (262.5 x 2)
- Removable 19" Rack mount brackets make this perfect for tabletop use or for rack mount applications
- Mic mixer: 3 front microphone inputs each with volume, tone, and echo control
- Built in preamplifier
- Built in Bluetooth with 35 Foot range
- USB input will play MP3 music files from a thumb drive or hard drive
- SD card playback will play MP3 music files stored on a memory card
- 3.5mm aux input for iPod/MP3 player or other audio device
- Built-in FM radio with manual tuning, and auto-scan
- Dual turbo cooling fan system
- Bright blue LED display
- Full function remote gives you easy access to all the important features
- Perfect for karaoke, DJ, KJ, home, and commercial applications
- Adjustable bass and treble music control
- Adjustable bass and treble mic control
- Delay and repeat effect controls
- Rugged metal housing
- 110V use only
- **Unit weight:** **SINGMIX 2:** 18.5lbs (8.4kg)/**SINGMIX 3:** 22.71lbs (10.3kg)
- **Shipping weight:** **SINGMIX 2:** 20.9lbs (9.5kg)/**SINGMIX 3:** 27.11lbs (12.3kg)
- Unit dimensions: 19.2" x 5.1" x 5.5" inch

SPECIFICATIONS

- THD: less than 0.1%
- Input sensitivity: 400mv/33K ohm
- Frequency response: (20Hz-20KHz): ± 2 dB
- Signal to noise ratio: 80db
- Tone characteristic (100Hz-10KHz) ± 12 dB
- 110V voltage power

TROUBLESHOOTING

No power	<ul style="list-style-type: none">• Make sure the unit is properly plugged in.• Check the fuse.
Bluetooth pairing fails	<ul style="list-style-type: none">• Make sure both devices are turned on and that your BT device is discoverable.• Make sure you've selected the proper source.• Make sure the BT device is within 5ft of the unit.• Move both devices away from other BT devices, micro-waves, wireless routers, and other electronics.• Make sure the unit is not paired to another device.
No sound	<ul style="list-style-type: none">• Make sure the correct input source is selected.• Check the master volume control as well as the volume settings of the input source.• Check all input connections as well as all output connections.
No video output	<ul style="list-style-type: none">• Check all video input and output connections.• Make sure your TV or other display device is set to the correct video setting.
Microphone feedback	<ul style="list-style-type: none">• Make sure the speakers are not pointed towards or are too close to the speakers.• Adjust the treble settings on the Mic EQ panel.
No sound from microphones	<ul style="list-style-type: none">• Make sure the microphones are turned on.• Check all mic connections.• Check individual microphone volume settings as well as master microphone volume.• Make sure the microphones are in proper working order.

רוקמה

FEDERAL COMMUNICATIONS COMMISSION COMPLIANCE INFORMATION

Responsible party name: Rockville

Address: 600 Bayview Ave,
Entrance A,
Inwood, NY 11096

Hereby declares that the product Rockville SINGMIX series Professional Karaoke Receivers comply with FCC rules as mentioned in the following paragraph:

This device complies with Part 15 of the FCC rules. Operation is subject to the following two conditions: (1) this device may not cause harmful interference, and (2) this device must accept any interference received, including interference that may cause undesired operation.

Note: This equipment has been tested and found to comply with the limits for a Class B digital device, pursuant to Part 15 of the FCC rules. These limits are designed to provide reasonable protection against harmful interference in a residential installation. This equipment generates, uses and can radiate radio frequency energy and, if not installed and used in accordance with the instructions, may cause harmful interference to radio communications. However, there is no guarantee that interference will not occur in a particular installation. If this equipment does cause harmful interference to radio or television reception, which can be determined by turning the equipment off and on, the user is encouraged to try to correct the interference by one or more of the following measures:

- Reorient or relocate the receiving antenna.
- Increase the separation between the equipment and receiver.
- Connect the equipment into an outlet on a circuit different from that to which the receiver is connected
- Consult the dealer or an experienced radio/TV technician for help.

רוסנקרם



RockvilleAudio.com

© 2019 ROCKVILLE // Features and specifications are subject to change and or improvement without notice.