

ROCKVILLE

RockNRide

3" POWERED BLUETOOTH HANDLE BAR
MOUNT MOTORCYCLE SPEAKERS

OWNER'S MANUAL

ATTENTION:
WATCH THIS VIDEO BEFORE FIRST USE!

Who reads manuals?

Scan the **QR code** or go to **rockvillesupport.com/rocknride** to access how-to video(s), the owner's manual, and other important information you may need to get the most out of your item.

If you prefer written instructions, please read ahead!

With Rockville you get many options.

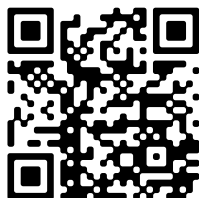

Missing items? If you ordered a bundle that includes more than one product and you are missing part of your bundle then it just means your order shipped from two different warehouses. You will receive the remaining items very soon. If you have any concerns or inquiries, feel free to call our customer support center at 1-646-758-0144, 24 hours a day/7 days a week.

רשתות

Thank you for purchasing these Rockville RockNRide 3" powered motorcycle handlebar mount Bluetooth speakers. These top quality metal speaker enclosures are waterproof (IP67 rating), unbreakable, and feature a built-in high power amplifier for easy installation to your handlebars with no exposed wire terminals. With 150 watt 3" speakers they are loud enough to be heard over engine noise, even when wearing a helmet. They also feature a built-in FM radio, Bluetooth connectivity, a USB 2.0 input, an RCA input, and a 3.5mm male AUX jack. Specifically designed to be attached to your motorcycle's handlebars, the RockNRide speakers have built-in durable metal handlebar mount brackets. We have spared no expense in manufacturing these speakers to meet the highest quality standards. With proper care and installation they will provide you with the highest levels of sound quality. We hope that these speakers will bring you years of performance and reliability.

Please read this installation guide carefully for proper use of your Rockville RockNRide 3" powered motorcycle handlebar mount Bluetooth speakers. Should you need technical assistance please call our technical help line at 1-646-758-0144, 24 hours a day/7 days a week.

INCLUDES

- 2 speakers (primary and secondary)
- 2 handlebar mounting sets with bracket and screws
- 4 rubber fitments inserts
- 1 wired remote
- 1 wire harness
- owner's manual
- warranty card

IMPORTANT SAFETY INSTRUCTIONS

- Be fully aware of all driving conditions and operate this device in a safe manner. Do not attempt to insert USB disk, connect an AUX cable, or pair to a Bluetooth device while operating your motorcycle.
- Do not kink, fold, or place heavy objects on the power cable. Doing so may damage the cable and create a fire hazard.
- Immediately turn off the speakers and disconnect the power cable if you smell smoke or see smoke coming from the speakers.
- Please note: static electricity will affect the performance of the speakers.
- Do not expose the speakers to extreme temperatures or conditions for extended periods of time.
- Never attempt to disassemble or repair the speakers on your own. There are no user serviceable parts, refer service to the Rockville service center.
- Please turn power off to the speakers before moving or removing them.
- Be sure to properly attach the power cable, AUX cable, and speaker cable to prevent accidents. Keep the cables away from torsion points, moving parts, and areas where they may be exposed to extreme heat.

PARTS

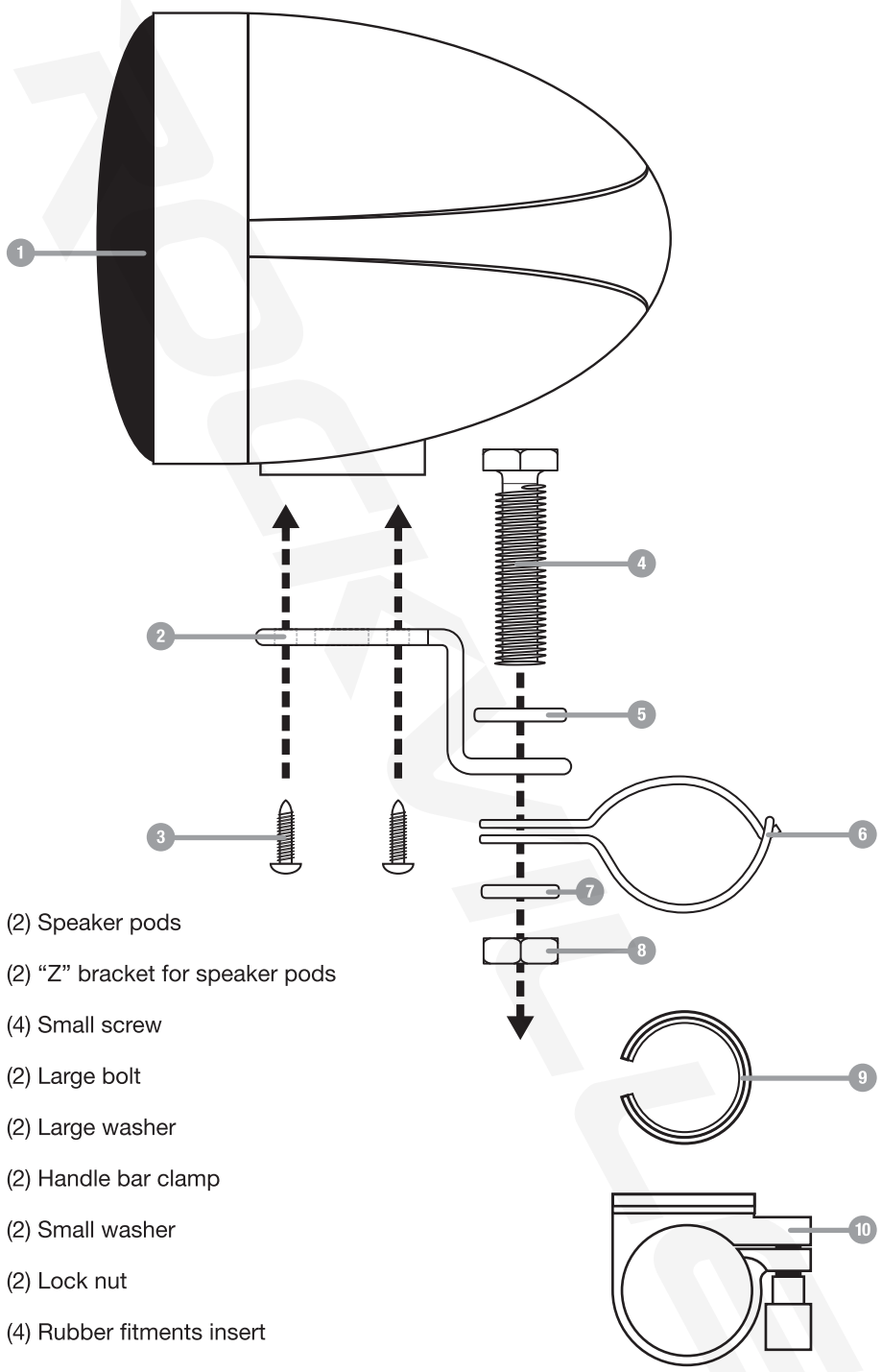

- 1. (2) Speaker pods
- 2. (2) “Z” bracket for speaker pods
- 3. (4) Small screw
- 4. (2) Large bolt
- 5. (2) Large washer
- 6. (2) Handle bar clamp
- 7. (2) Small washer
- 8. (2) Lock nut
- 9. (4) Rubber fitments insert
- 10. (1) Remote control handle bar mounting bracket

WIRING HARNESS

USB input cable

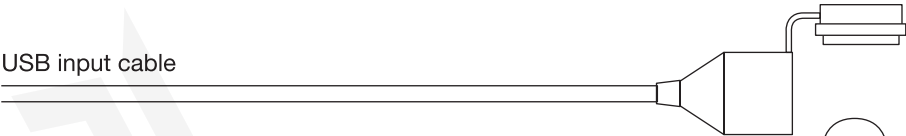

RCA input cable



3.5mm Wired remote control port cable

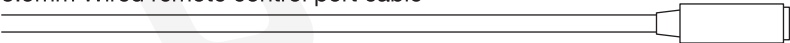

Red +12V (POS) power cable

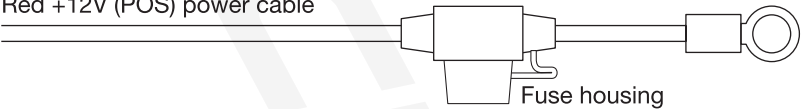

Black ground (NEG) cable



3.5mm male line in cable



WIRED REMOTE CONTROL

- 1. Power/Mode button: Long press to power on/off.
Short press to change modes: USB, FM, Bluetooth,
Line in.
- 2. Volume - / Volume + buttons
- 3. FM indicator LED
- 4. Previous station-track / Next station-track buttons
- 5. Play/Pause/FM scan button: Short press to pause/
play current track. Long press for FM station auto
scan and store.
- 6. MP3 indicator LED

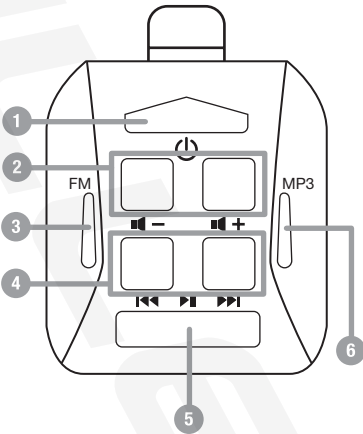

MOUNTING THE SPEAKERS

1. Spread open one of the handle bar clamps and place it onto the handle bars of your motorcycle. If necessary, use one of the four included rubber fitments inserts.

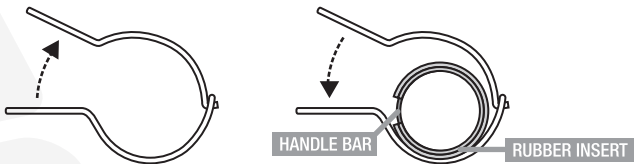

2. Slide a large washer onto one of the large bolts, followed by the one of the “Z” brackets and slide these through the corresponding hole in the handle bar clamp (fig A). Now slide a small washer onto the bolt and screw on the lock nut (fig B). Tighten the lock nut until the clamp is firmly secured to the handlebars (fig C). Do not over tighten.

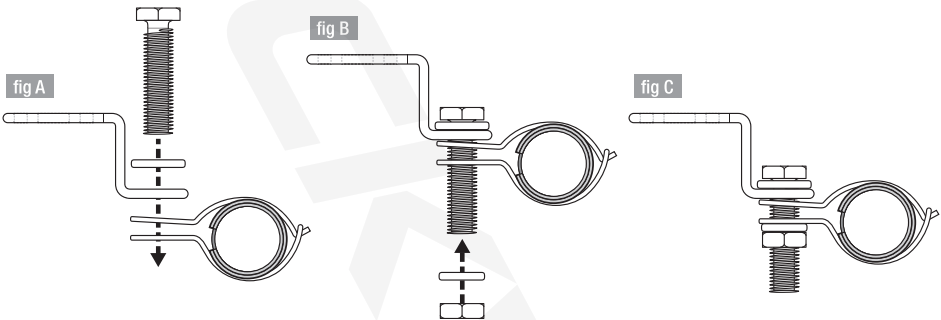

3. Use two small screws to attach the speaker pod to the “Z” bracket (fig D). Once the pod is attached, sit on the motorcycle, slightly loosen the lock nut, and adjust the orientation of the speaker pod by turning the “Z” bracket in the desired direction (fig E). Set the unit so that the speakers are facing towards the head of the rider in order to achieve optimal effect. Make sure that the unit does not obstruct the instrument panel.

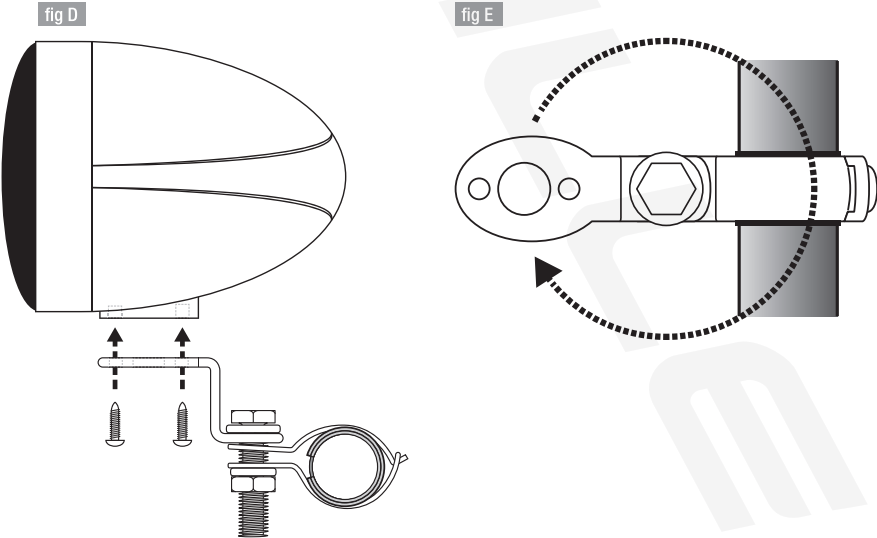

POWERING THE SPEAKERS

1. Guide the power cables along the handle bars towards the neck of the motorcycle and down towards the battery. Secure the cables with cable ties (not included). Keep the cables away from torsion points, moving parts, and areas where they may be exposed to extreme heat.
2. Connect the black cable to the negative terminal of the battery. Connect the red cable to the positive terminal of the battery. Be sure to tighten the battery terminals.

ACCESSORY CABLES

Guide the additional cables (USB, RCA, LINE IN, and remote control link) to a location where they will be easily accessible. Be sure to secure the cables with cable ties and be mindful to keep the cables away from torsion points, moving parts, and areas where they may be exposed to extreme heat.

FUNCTIONS

BLUETOOTH PAIRING

To connect your iPod, iPhone, MP3 player, Android phone or any other Bluetooth capable device follow the steps listed below.

1. Make sure the unit is on.
2. Short press the Power/Mode button until you hear a voice prompt indicating the unit is now ready to pair.
3. Turn on the Bluetooth feature on your device and ensure that it is in “discoverable” mode. Search for “RockNRide” on your list of available devices and select it.
4. Upon successful pairing you will hear a voice prompt indicating you may now play music via your Bluetooth enabled device.
5. Press Play/Pause button to start and pause audio playback.
6. Press the Previous/Next buttons to navigate through tracks.
7. Press the Vol-/Vol+ buttons to decrease or increase the volume.

RADIO

1. Press the Power/Mode button until the FM mode indicator LED lights up.
2. Long press Play/Pause/FM scan button to automatically search and store stations.
3. Press the Previous/Next buttons to navigate through stored stations.
4. Press the Vol-/Vol+ buttons to decrease or increase the volume.

USB/SD

1. Inserting a USB drive into the corresponding port will set the unit to USB mode and it will automatically begin to play tracks.
2. Press the Previous/Next buttons to navigate through tracks.
3. Press the Vol-/Vol+ buttons to decrease or increase the volume.

AUX

1. Connect any device with a 3.5mm output to the unit via its 3.5mm line input.
2. The unit will automatically switch to AUX mode when a signal is detected.
3. Use your device's controls to select tracks.
4. Press the Vol-/Vol+ buttons to decrease or increase the volume.

RCA

1. Connect any device with an RCA output to the unit via its RCA line input.
2. The unit will automatically switch to AUX mode when a signal is detected.
3. Use your device's controls to select tracks.
4. Press the Vol-/Vol+ buttons to decrease or increase the volume.

MOUNTING THE REMOTE CONTROL

1. Loosen the locking screw on the remote control mounting bracket (fig F). Pull open the bracket and place it onto the handle bars of your motorcycle. Make sure the locking screw is facing towards the front of the motorcycle. If necessary, use one of the four included rubber fitments inserts. Place the bracket at the desired angle and tighten the locking screw (fig G).

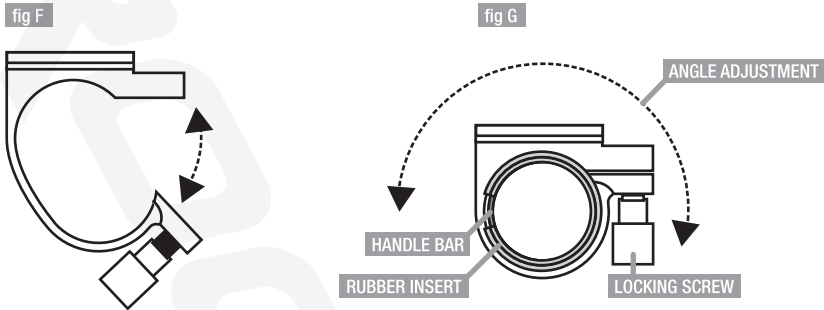

2. Slide the remote control module onto the bracket as indicated (fig H). You will hear a click when the module is properly seated. To remove the remote, press the tab at the top of the remote unit and slide the remote control back (fig I).

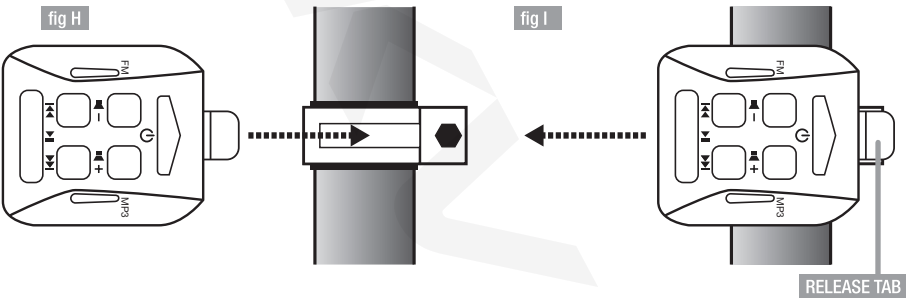

WIRING THE REMOTE CONTROL

Guide the remote module male 3.5mm cable to the location of the 3.5mm female jack originating at the speaker. Be sure to secure the cable with cable ties (not included) and be mindful to keep the cable away from torsion points, moving parts, and areas where it may be exposed to extreme heat.

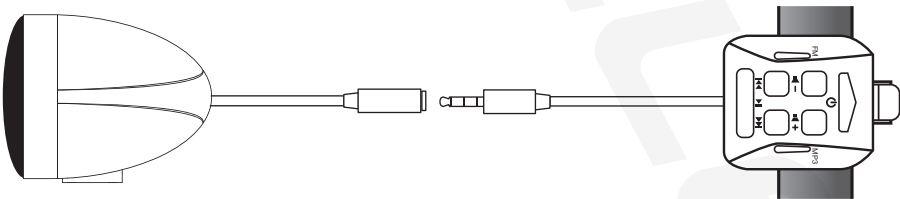

FEATURES

- Pair Rockville RockNRide 3" Motorcycle Powered Bluetooth Handlebar Mount Speakers
- Completely waterproof with IPX67 rating
- Built-in Bluetooth, USB, FM radio, 3.5mm AUX input, RCA input
- Top quality metal speaker enclosures are waterproof and unbreakable
- Built-in high powered amplifier for easy installation with no exposed wire terminals
- Extremely powerful to be heard over the engine noise of a motorcycle even while wearing a helmet
- 300 Watts Peak
- 150 Watts RMS
- Working voltage: 10V – 24V DC
- MOSFET power supply
- Impedance: 4 Ohms
- Built-in Bluetooth audio streaming with 33 foot range
- Automatically remembers and syncs with previously synced devices
- Compatible with any Bluetooth devices such as smartphones, tablets, etc
- Frequency response 20Hz to 20KHz, SN >50dB, THD: < 0.1%
- FM radio frequency: 87.5Hz – 108.0Hz
- Auto-scan of available FM radio stations (no manual tuning)
- RCA input allows you to listen to any audio device through these speakers
- 3.5mm female Jack for Wired Remote Control
- 3.5mm male AUX input allows you to connect any audio device
- Built-in USB 2.0 input with waterproof cover allows you to listen to a thumb drive with music on it (max 32gb)
- Wired remote included
- Universal for motorcycle, ATV, motorbike, snowmobile, scooter, etc
- 360° free rotating bracket is adjustable to fit 0.75" – 1.25" Handle Bars
- Thermal, overload, circuit protection

TROUBLESHOOTING

No power	Check for loose or disconnected cables (power and ground). Check for blown fuses. Make sure to replace fuse with one of the same type.
Poor radio reception	Make sure ground wire is properly connected.
Failure to read USB flash drive	Check that the USB drive is properly plugged in. Check that media files are in the proper format (WMA, MP3)
Bluetooth	Check to see that both devices are turned on and that your Bluetooth device is discoverable. Turn both devices off and then on again. Make sure you've selected the proper source. Make sure that the Bluetooth device is within 5 feet of the unit. Make sure that the unit is not paired to a previously paired device.

מרכז
למחקר
והסברה
במלחמת
הטרור

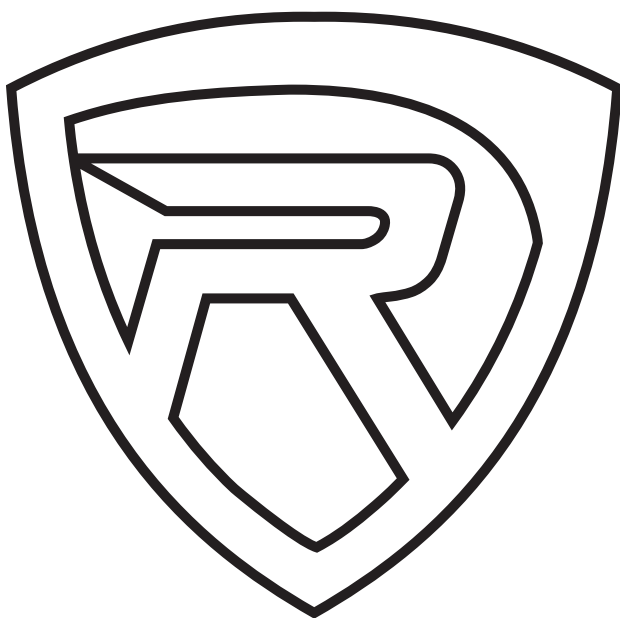

RockvilleAudio.com

© 2023 ROCKVILLE // Features and specifications are subject to change and/or improvement without notice.