

RT6

1 INCH SWIVEL SILK DOME NEO TWEETER

INSTALLATION GUIDE



Scan the QR code or go to rockvillesupport.com/rt6 to access an informational video, the owner's manual, and other important information you may need to get the most out of your item.

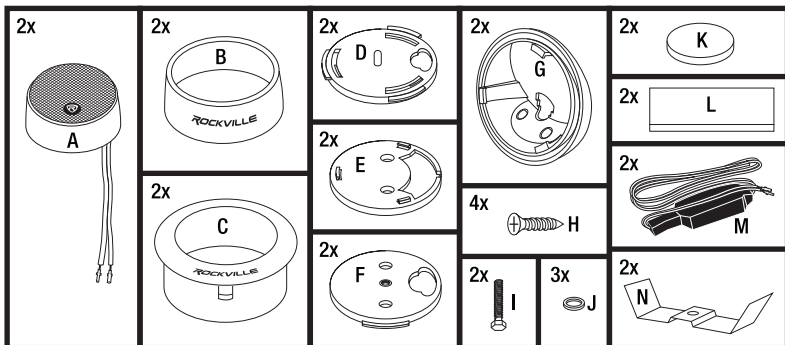

SPECIFICATIONS

- Power RMS: 30 Watts Each/60 Watts Per Pair
- Peak Power: 120 Watts Each/240 Watts Per Pair
- Impedance: 4 Ohm
- Cutout Diameter: 2.00"
- Mounting Depth: 0.75"
- Frequency Response: 1.3KHz – 24KHz
- Sensitivity: 93dB @ 1w/1m

FEATURES

- 1" Swivel Silk Dome Tweeters
- Complete Pair with Flush, Surface, and Angle Mount Hardware
- Neodymium Magnet
- Ferro-Fluid Cooled Voice Coil
- High Temperature ABS Housing
- In-Line Crossover Network

INCLUDED

- A. Tweeter
- B. Tweeter housing
- C. Flush mount housing
- D. Tweeter housing backing
- E. Surface mount plate
- F. Flush mount plate
- G. Angle mount housing
- H. Mounting screws
- I. Flush mount screw
- J. Washer
- K. Circular adhesive foam pad
- L. Rectangular adhesive foam pad
- M. In-line crossover
- N. Flush mount anchor

CUT-OUT TEMPLATE, 1:1 SCALE
DIAMETER: 2.00"

