

ROCKVILLE

RockNGo8 V2

8" PORTABLE POWERED RECHARGEABLE SPEAKER
w/BLUETOOTH, USB, SD, FM RADIO, & 2 WIRELESS MICS

OWNER'S MANUAL

Missing items? If you ordered a bundle that includes more than one product and you are missing part of your bundle, then it just means your order shipped from two different warehouses. You will receive the remaining items very soon. If you have any concerns or inquiries, feel free to call our customer support center at 1-646-758-0144, Monday through Thursday, 9am to 10pm EST, and Fridays, 9am to 3pm EST.

ROCKWELL

Thank you for purchasing this Rockville RockNGo8 V2 8" portable powered rechargeable speaker.

Portable, powerful and versatile; the Rockville RockNGo lets you take your music wherever you need to go. This versatile system features a 5 Band Equalizer, Built in USB and SD Slots, Rechargeable Battery, 1 Wireless VHF Mic, Built In Bluetooth, and professional inputs and outputs. With a high quality rechargeable battery, compact light-weight design, and integrated carrying handles and wheels, you can easily pick up and go with your Rockville RockNGo system.

Please read this owner's manual carefully for proper use of your Rockville RockNGo8 V2. Should you need technical assistance please call our technical help line at 1-646-758-0144, Monday through Friday, 9am to 5pm EST.

IMPORTANT SAFETY INSTRUCTIONS



TO REDUCE THE RISK OF ELECTRICAL SHOCK, DO NOT REMOVE AMPLIFIER PLATE. NO USER SERVICEABLE PARTS INSIDE. WE RECOMMEND TAKING THE UNIT TO A QUALIFIED SERVICE TECHNICIAN FOR ANY REPAIRS.

- Do not place these speakers on an unstable surface. The speaker may fall over, causing serious injury to a child or adult and serious damage to the unit.
- Do not use these speakers near water; for example, near a bathtub, sink, in a wet basement, or near a swimming pool.
- The speakers should be situated away from heat sources such as radiators, heat registers, stoves, or other devices that produce heat.
- Clean only with a soft damp cloth. Unplug the main unit from the wall outlet before cleaning.

ROCKWELL

INCLUDES

- 8" Active/powerd speaker with built-in Bluetooth
- 3.5mm to dual RCA cable
- 3.5mm to 3.5mm cable
- 1 Wireless Microphone
- 1 Mic holder
- Remote
- Power cable

REMOTE CONTROL FUNCTIONS

 : Power/Standby

USB: USB input

SD: SD input

FM: enter FM radio mode

AUX: auxiliary input

BT: enter Bluetooth mode

EQ: access preset EQ settings (USB/SD/BT)

TUNE +/- : manually tune FM stations

 / AUTO: Play/Pause (USB/SD/BT) /
automatic station search in FM mode

CH- /  : previous FM station/previous track (USB/SD)

CH+ /  : next FM station/next track (USB/SD)

MIC PRIORITY: enter mic priority mode

SAVE: save FM stations to memory

DISP +/- : adjust display brightness

VOL +/-: master volume control

RECORD: activate record function (USB/SD)

REC.PLAY: playback recording (USB/SD)

0 – 9: number pad used to direct select tracks
when in USB/SD mode

REPEAT: repeat one song/repeat all songs/shuffle

RESET: reset volume level

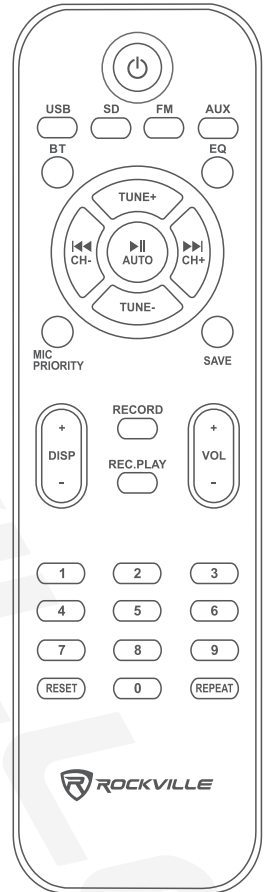

FRONT PANEL

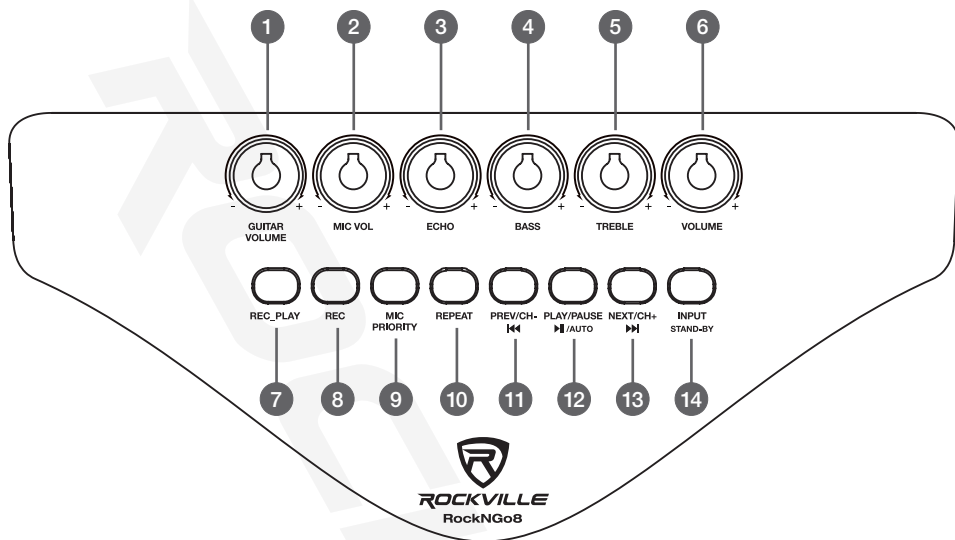

1. Guitar volume control
2. Mic volume control
3. Echo control
4. Bass control
5. Treble control
6. Master volume
7. REC_PLAY button: play back recordings from MIC input
8. REC button: activate record function (USB/SD)
9. MIC_PRIORITY button: activate MIC priority function which lowers the music volume when you talk into the mic.
10. REPEAT button: activate repeat modes. Press once to repeat a single track, press twice to repeat all tracks, press three times for random play.
11. PREV/CH- / ◀◀ button: previous FM station/previous track (USB/SD)
12. PLAY/PAUSE / ▶▶ / AUTO button: Play/pause (USB/SD/BT) / Automatic station search in FM mode.
13. NEXT/CH+ / ▶▶▶ button: next FM station/next track (USB/SD)
14. INPUT ST.BY button: press to turn-on the speaker. Press and hold to turn off the speaker. Once the unit is on, press the button to switch input mode.

TOP PANEL

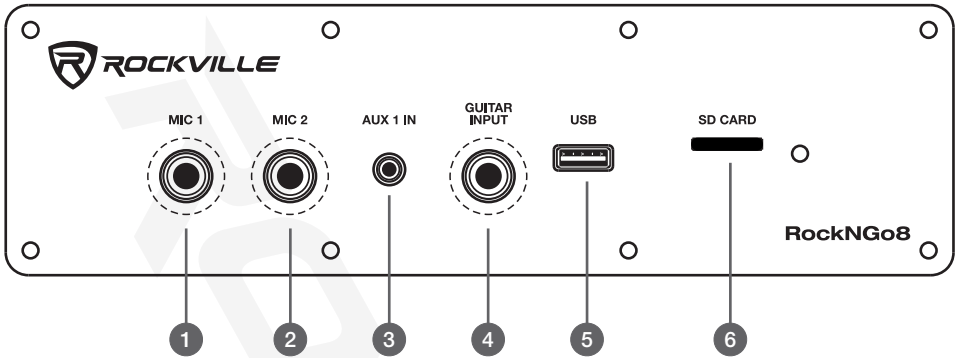

1. 1/4" MIC input 1
2. 1/4" MIC input 2
3. 3.5mm AUX 1 input
4. 1/4" guitar input (you may connect other line level devices as well)
5. USB input (does not support charging)
6. SD card input

REAR PANEL

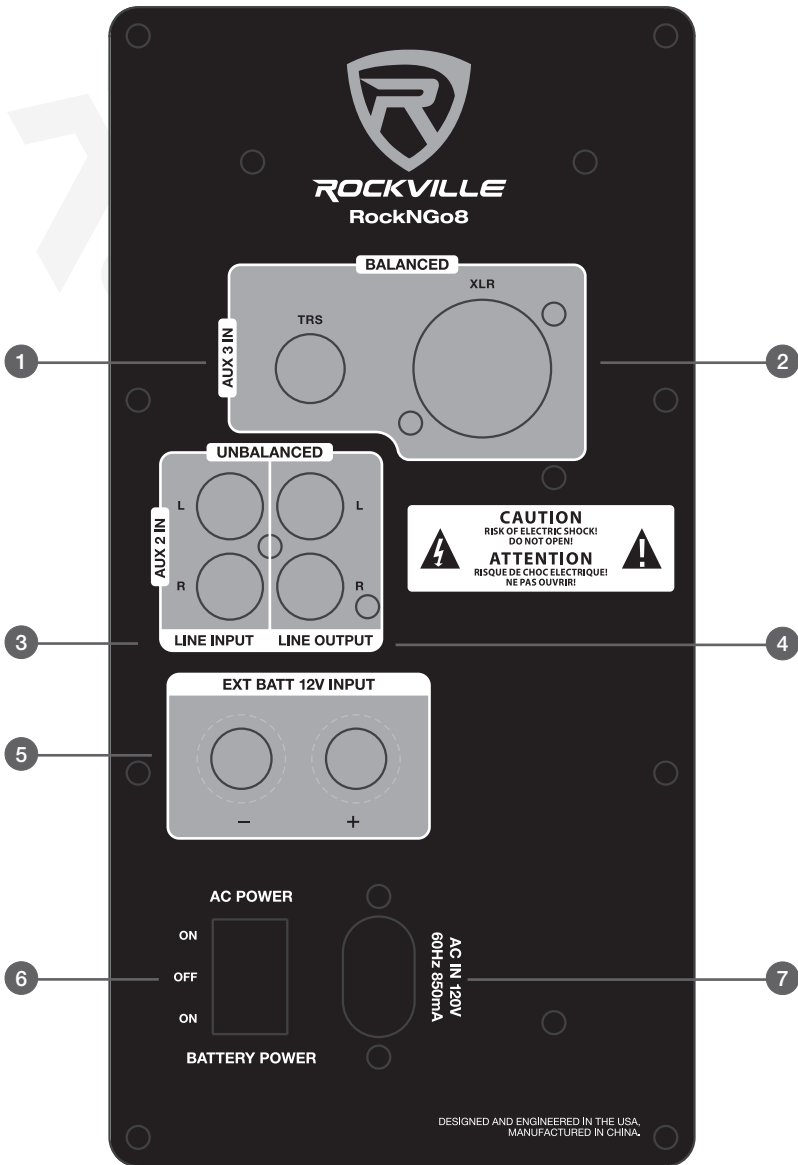

1. Balanced ¼" TRS input
2. Balanced XLR input
3. L/R RCA line input
4. L/R RCA line output
5. External battery inputs

BLUETOOTH

To connect your iPod, iPhone, MP3 player, Android phone or any other Bluetooth capable device follow the steps listed below.

1. Make sure the power switch is in the ON position.
2. Press the BT button on the remote control or push the INPUT button on the unit until the digital read out shows “bLU”.
3. Turn on the Bluetooth feature on your device and ensure that it is in “discoverable” mode. Search for “RockNGo8 V2” on your list of available devices and select it.
4. Upon successful pairing you will hear a tone indicating you may now play music via your Bluetooth enabled device.

FM RADIO

For FM radio follow the steps listed below.

1. Make sure the power switch is in the ON position.
2. Press the FM button on the remote control or push the INPUT button on the unit until the digital read out shows numbers.
3. While in FM mode, press the AUTO button to activate automatic station search. Use the CH+/- buttons to manually search through stations.

USB/SD

For USB/SD playback follow the steps listed below.

1. Make sure the power switch is in the ON position.
2. Press the USB or SD button on the remote control or push the INPUT button on the unit until the digital read out shows “USb”.
3. Plug in your SD card or USB flash drive. The unit will automatically read the files and begin playing music.

MIC/GUITAR INPUT

To use the system for karaoke connect any microphone via either one of the 1/4” inputs located on the top of the unit. You can control the MIC volume and echo settings by using the MIC VOLUME and ECHO knobs on the front of the unit. Use the MIC PRIORITY function to give priority to microphone during musical playback. This means that the music volume will drop while either mic is in use.

To connect a guitar or any other instrument/audio device, use the 1/4” input on the top of the unit labeled GUITAR INPUT. Use the GUITAR VOLUME knob on the front of the unit to independently control this input's volume.

AUX INPUTS

AUX 1: Plug a 3.5mm cable into the AUX 1 input on the top of the unit and it will automatically switch to AUX mode. Use this port to connect your laptop, music player or any other audio playback device with a 3.5mm output.

AUX 2: You can use this RCA Line Input when you wish to hook up an additional stereo signal source: iPhone, iPad, Android phones, TV, CD players, DVD music players, MP3 players etc.

AUX 3: These inputs are primarily intended for mixers but can be used for other signal sources such as keyboards, electronic drums, tape recorders, etc.

RECORDING

The RockNGo features a record function. Simply press the REC button located on the front panel and the unit will record to a plugged in USB drive or SD card. To listen to your recordings, press the REC_PLAY button located next to the REC button on the front panel.

BATTERY

The RockNGo8 V2 comes with a convenient built-in 12V-7.5Ah. This convenient features allows you to use your RockNGo unit for up to 8 hours in any situation where outlets are not readily available. No need to concern yourself with extension cords and the such. To charge the battery simply plug it into an outlet. Battery takes approximately 8 hours to fully charge. When the battery is drained it is important that you immediately turn off your unit to prevent damage to the battery.

This unit is equipped with Intelligent Battery Management function. When the battery power is low the speaker will emit a tone and the battery sign in the LCD readout will flash. At this point, if the unit is not promptly charged it will shut down.

EXTERNAL BATTERY POWER

As well as having a built-in battery, the RockNGo8 V2 also has the ability to power up using an external battery. Simply hook the unit up to any 12V car battery or 12V power source. We recommend you use spade terminals to connect the power cables to the unit's power and ground inputs. Remember, RED is POSITIVE (+12V) and BLACK is NEGATIVE (-).

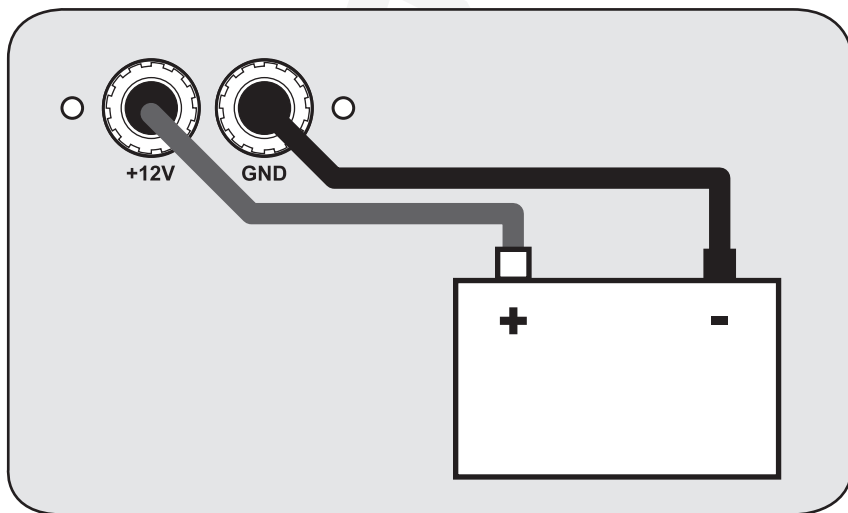

ATTENTION



1. If the RockNGo will not be used for a prolonged period of time make sure that the power switch is in the OFF position and that the battery is fully charged every 3 months.

ROCKWELL

FEATURES

- 360 Watts peak power
- 180 Watts program power
- 90 Watts RMS
- High power class D amplifier
- 5 Band equalizer on MP3 player (preset EQ curves for Bluetooth, USB, and SD mode)
- XLR audio Input
- ¼" audio input
- 3.5mm line input
- 2 Mic Input (¼")
- 1 ¼" Line input with volume control (for Guitar or any audio device or instrument)
- 1 RCA input
- 1 RCA output
- Guitar input volume control
- Mic volume and echo controls
- Bass/ Treble/ Volume (master) controls
- Built-in USB (2.0)
- Built-in SD card reader (Mini SD)
- LCD display for MP3 player
- Built-in FM radio tuner
- Built-in Bluetooth with a range of 35 feet
- Record function will record your output onto the SD card or USB
- Wireless VHF mic receiver built-in with Mic included (additional wireless mics sold separately)
- Mic priority option gives you the option to lower the music when you talk into the mic or you can talk/sing along with the music
- Built-in 12V – 7.5Ah battery for portability
- Optional external 12V battery connection for extended play time
- Speaker can play for 4 – 8 hours per charge depending on volume level
- AC power input with built-in battery charger
- Strong MDF housing, metal grill, strong plastic panels, aluminum trolley bracket, and strong plastic double wheels.
- Built-in wheels and trolley for easy transport
- Big power 8" woofer with ASV voice coil
- Large 3" tweeter gives incredible highs!
- Computer tuned port gives added bass punch
- Frequency response: 40Hz – 20KHz
- S/N Ratio: $\geq 75\text{dB}$
- Separation: \geq to 50dB
- Input impedance: 10K ohm balances
- High frequency adjustable from -2dB, -1dB, 0, 1dB
- System volume: -30dB – +6dB
- Unit weight: 22.1 lbs
- Unit dimensions in inches (W x H x D): 11.02" x 17.72" x 12.20"

TROUBLESHOOTING

PROBLEM	SOLUTION
No power	<ol style="list-style-type: none">1. Make sure the unit is plugged in.2. Check that the power switch is in the AC POWER ON position.3. If the power switch is in the BATTERY POWER ON position and there is no power, the unit needs to be charged.4. If connected to an external 12V power source, check the connections and make sure the external battery is charged.
No sound	<ol style="list-style-type: none">1. Make sure you've selected the proper source.2. Make sure the volume is turned up.3. Make sure the MIC is turned on and that the MIC volume is turned up.4. Check that all appropriate input cables are plugged in correctly.5. If using the GUITAR input make sure that the guitar volume is turned up and that the guitar cable is properly plugged in.
Bluetooth pairing fails	<ol style="list-style-type: none">1. Check to see that both devices are turned on and that your Bluetooth device is discoverable.2. Turn both devices off and then on again.3. Make sure you've selected the proper source.4. Make sure that the Bluetooth device is within 5 feet of the unit.5. Move both devices away from other Bluetooth devices, microwaves, wireless routers, and other electronics.6. Make sure that the unit is not paired to a previously paired device.
Files on SD or USB memory device will not play back	<ol style="list-style-type: none">1. Make sure you've selected the proper source.2. Make sure that the audio files are in the specified format (see Features section).
No sound when receiving TV input	<ol style="list-style-type: none">1. Select proper audio option from TV.2. If using RCA cables, make sure that they are plugged into the output jacks of the TV and the input jacks of the speaker.

ROCKWELL

FEDERAL COMMUNICATIONS COMMISSION COMPLIANCE INFORMATION

Responsible party name: Rockville

Address: 600 Bayview Ave,
Entrance A,
Inwood, NY 11096

Hereby declares that the product Rockville RockNGo8 V2 8" portable powered rechargeable speaker complies with FCC rules as mentioned in the following paragraph:

This device complies with Part 15 of the FCC rules. Operation is subject to the following two conditions: (1) this device may not cause harmful interference, and (2) this device must accept any interference received, including interference that may cause undesired operation.

Note: This equipment has been tested and found to comply with the limits for a Class B digital device, pursuant to Part 15 of the FCC rules. These limits are designed to provide reasonable protection against harmful interference in a residential installation. This equipment generates, uses and can radiate radio frequency energy and, if not installed and used in accordance with the instructions, may cause harmful interference to radio communications. However, there is no guarantee that interference will not occur in a particular installation. If this equipment does cause harmful interference to radio or television reception, which can be determined by turning the equipment off and on, the user is encouraged to try to correct the interference by one or more of the following measures:

- Reorient or relocate the receiving antenna.
- Increase the separation between the equipment and receiver.
- Connect the equipment into an outlet on a circuit different from that to which the receiver is connected.
- Consult the dealer or an experienced radio/TV technician for help.

ROCKVILLE

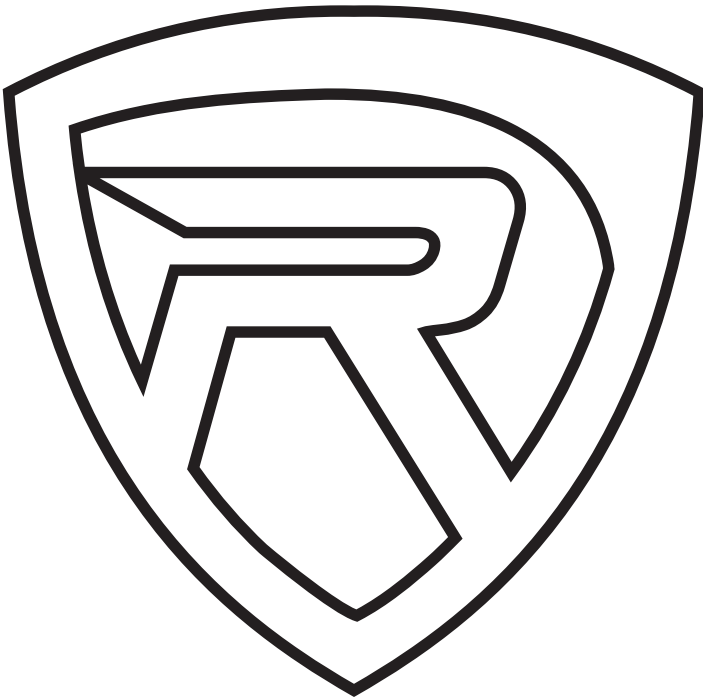

RockvilleAudio.com

© 2020 ROCKVILLE // Features and specifications are subject to change and or improvement without notice.