

ROCKVILLE ROCKSLIM

Owner's Manual

WHO READS MANUALS?

Scan the QR codes or go to the URLs to access how-to video(s), the owner's manual, and other important information you may need to get the most out of your item.



rockvillesupport.com/rockslim-black



rockvillesupport.com/rockslim-white

Thank you for purchasing this Rockville ROCKSLIM 5.25" super thin wall mount speakers. Please read this owner's manual carefully for proper use. Should you need assistance, please call our technical help line at 1-646-758-0144, 24 hours a day/7 days a week.

IMPORTANT SAFETY INSTRUCTIONS

1. When the speakers are mounted on the wall, make sure the wall structure is reliable and the speakers are firmly attached.
2. Install the speaker in a location that can structurally support the weight of the speaker and its mounting hardware. Otherwise it may result in the unit falling down and possibly causing personal injury.
3. Do not use nails, adhesives or other unauthorized devices. Long-term use and vibrations may cause it to fall easily.
4. Do not touch or bump woofer and tweeter. If these are damaged, the sound will be distorted.
5. Make sure the volume is turned down when you are installing/removing cables or changin the input source. Failing to do so may cause damage to the speaker.

FEATURES and SPECIFICATIONS

- Rockville RockSlim Super Thin Wall Mount Speaker
- Easily hangs on your wall – just as easy as hanging a picture!
- Hanging bracket is molded into the speaker
- Recessed spring loaded speaker wire terminals make it easy to hide wires behind the speaker
- Molded speaker wire groove makes it easy to run speaker wires behind the speaker
- RMS Power: 40W per speaker (80W per pair)
- Peak Power: 120W per speaker (240W per pair)
- 5.25" woofer with paper cone has natural sound reproduction with clear mids and bass
- 0.5" Mylar dome tweeter delivers pristine highs
- Beautiful sleek design is perfect for a living room, bedroom, kitchen, restaurant, and more
- Elegant simple design blends in
- Cabinet Material: ABS
- Shielded grill offers additional protection from dust and damage
- Frequency Response ($\pm 3\text{db}$): 100Hz – 20kHz
- Sensitivity: 89dB
- Nominal Impedance: 8 Ohm
- Weight: 2lbs (each speaker)
- Speaker dimensions: 10.8" x 7.3" x 1.38"

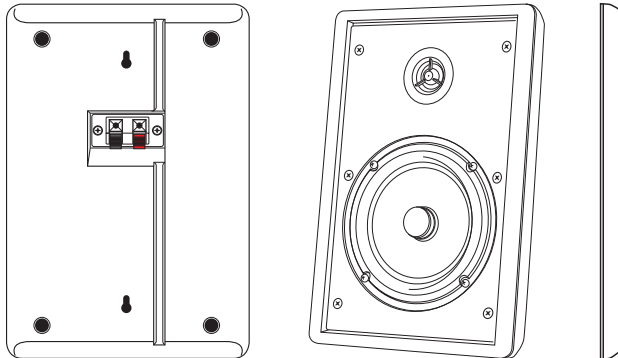

CONNECTIONS

Turn off all equipment before making any connections. When connecting the speakers, be sure to retain the correct polarity. Most speakers will have a red positive (+) terminal and a black negative (-) terminal.

PLEASE NOTE:

Most speaker damage is caused by amplifiers with too little power (wattage). An overdriven amplifier clips the waveforms and leads to speaker distortion. Clipping is usually audible and it may vary from a harsh sound to a fuzzy or unclear sound. If you notice clipping at high volume levels, turn down the volume until the distortion is gone. Damage caused by operating the speakers at distorted volume levels is not covered by the warranty.

MOUNTING

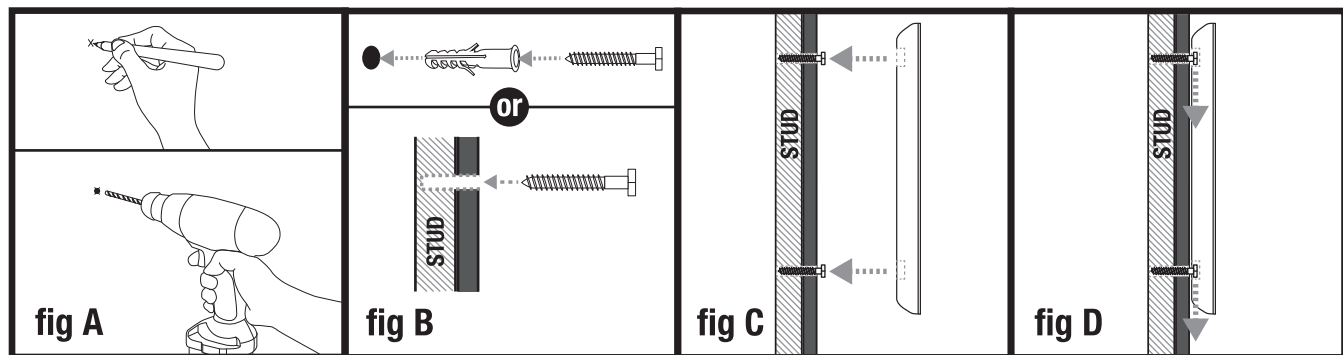

To mount the ROCKSLIM speaker, make marks on the wall where you wish to mount the speaker. Using a drill, make holes where you made your mark (fig A). We recommend using wall anchors (fig B; not included) or drilling into a stud. If you are using anchors, make sure the holes are deep enough to accomodate them. Once the mounting screws (not included) are in place simply lift the speaker, align the screws with the mounting holes and slide onto the screws (fig C). Now tug the speaker down slightly to ensure that it is seated properly (fig D). Repeat these steps for your other speakers.

CARE AND MAINTENANCE

Make sure to turn all equipment off before cleaning. The cabinet only needs occasional dusting. Please do not touch the drive units. Do not attempt to clean the speakers with chemical solvents as this may damage the paint surface. Clean with a dry cloth.