

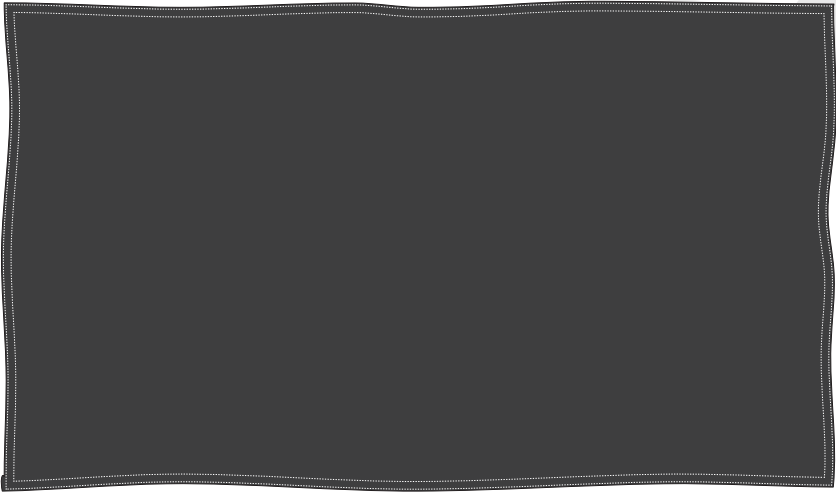





RFAA

Assembly Instructions

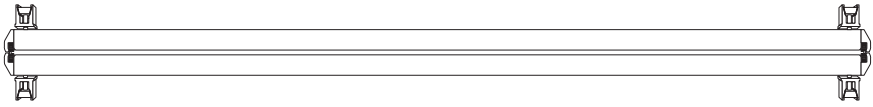
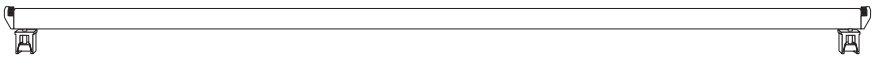
Thank you for purchasing the RFAA Event Façade with Travel Bag. Please read these instructions carefully before use. Make sure all parts are included. If any parts are missing please contact our technical help line at 1-646-758-0144, Monday through Friday, 9am to 5pm EST. Also you can check out our informational video on YouTube: <https://www.youtube.com/watch?v=fqhSKJ4acVc> or search for Rockville RFAA.

	4 pcs.
	8 pcs.
	3 pcs.
	2 pcs.
	1 pc.
Oversized carry bag	1 pc.

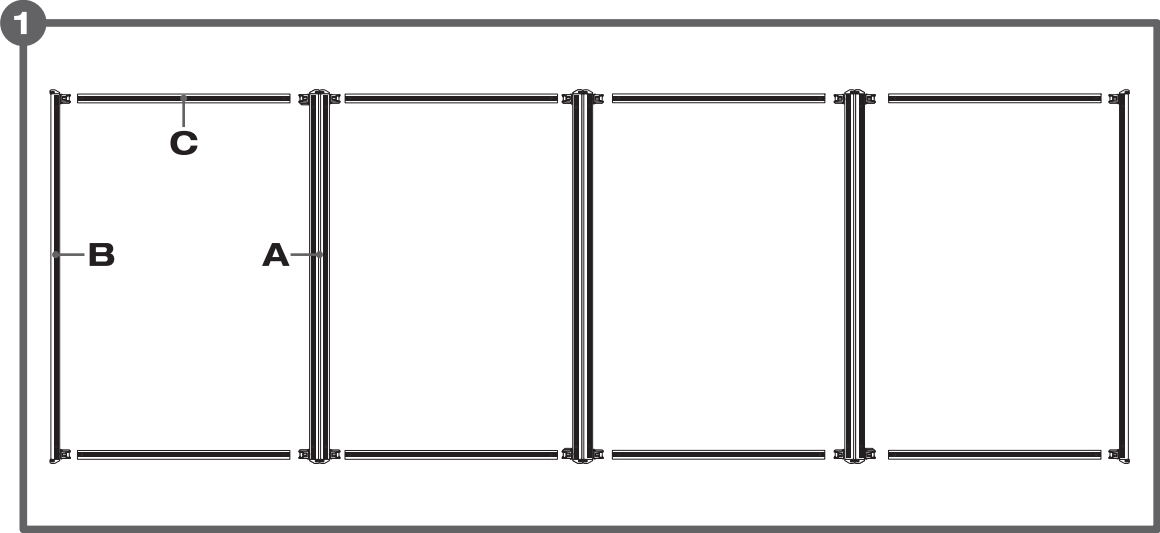

Find a large open space and lay out the 3 long hinged pieces (A), the 2 long end pieces (B), and the 8 horizontal pieces (C) velcro side up. You will need a space of at least 6ft x 11ft

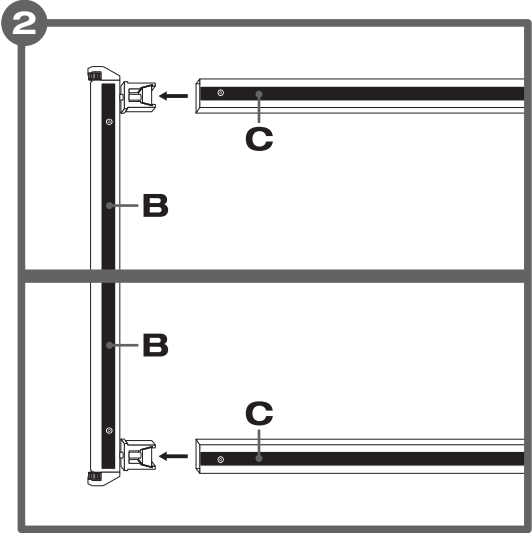

Begin by joining a horizontal piece (C) to each end of a long end piece (B). If you have trouble joining the pieces, try loosening the locking connectors with the included allen wrench (see fig 7).

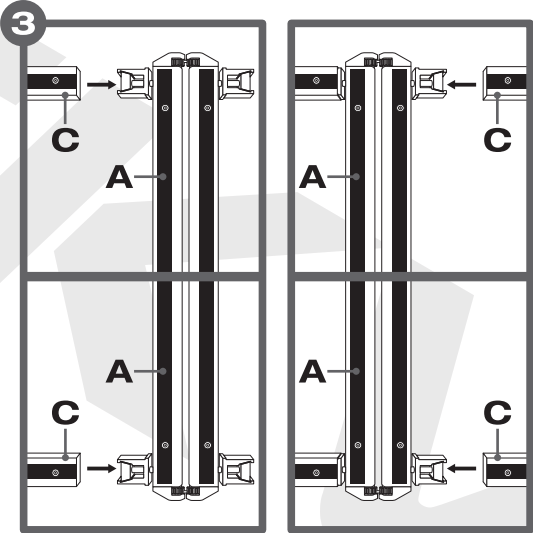

Join a long hinged piece (A) to the horizontal pieces (C) that were attached to the end piece in figure 2. Now attach two horizontal pieces to the other side of the long hinged piece. Continue until you've assembled the whole frame.

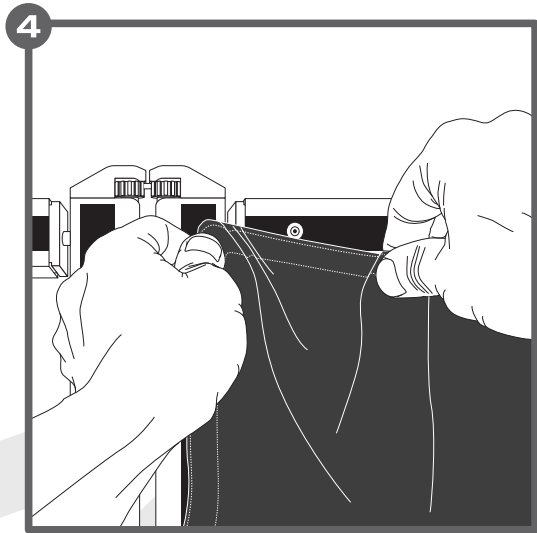

Once the frame is assembled it is time to attach the scrims. Begin by attaching the top and bottom ends of the scrim, starting at the corners and working your way across. Be sure to pull the scrim taught as you attach it.

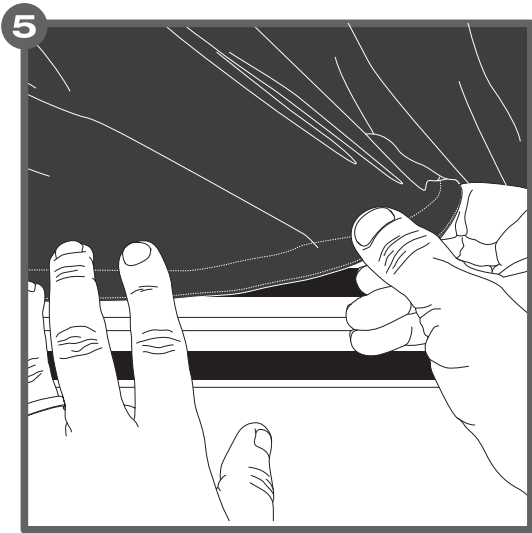

Now attach the left and right sides of the scrim. Start at the center and work your way left and right. Be sure to pull the scrim taught.

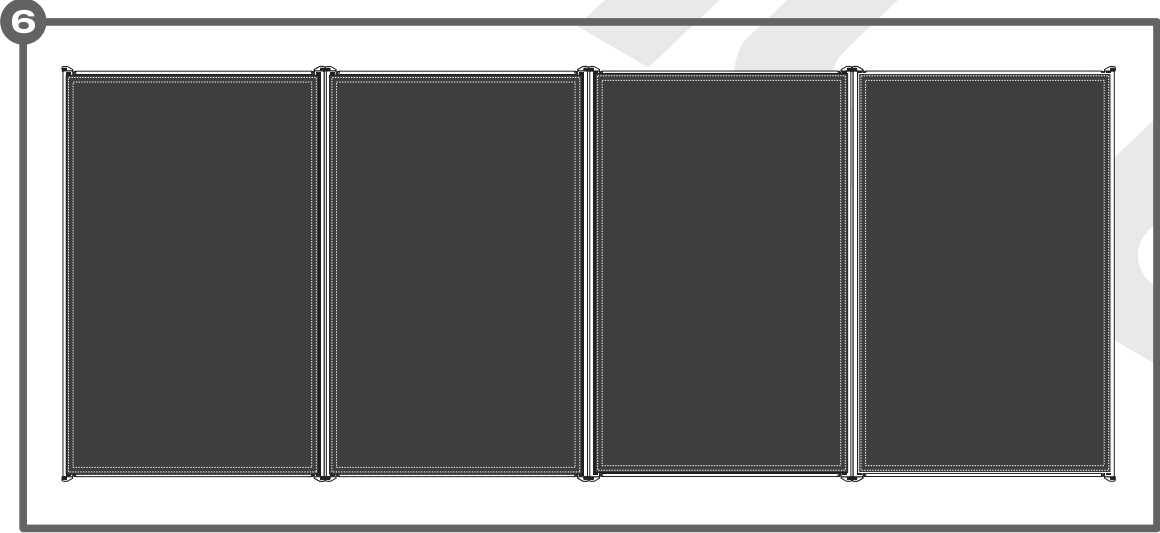

Once the scrims are attached you may go back and adjust them as needed to ensure they are taught and securely attached. Be sure to overlap the velcro a bit so you can't see it on the other side.

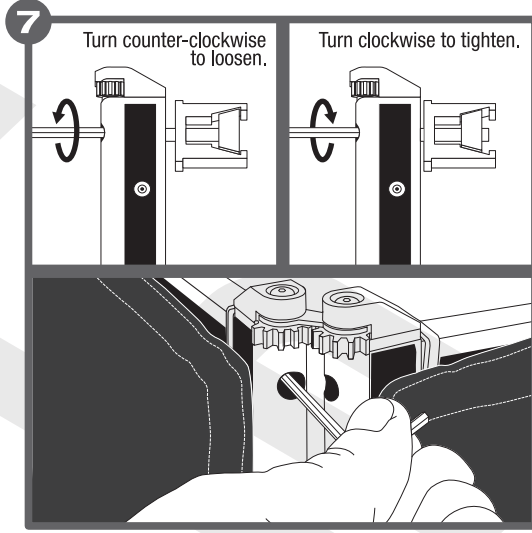

The final step is to tighten all the connectors. This will make the frame stiff which will allow it to stand without falling over. Do not overtighten.