

ROCKVILLE

RDM18 V2

SINGLE DIN RECEIVER w/BLUETOOTH,
USB, SD, and AM/FM RADIO

OWNER'S MANUAL

ATTENTION:
WATCH THIS VIDEO BEFORE FIRST USE!

Who reads manuals?

Scan the **QR code** or go to **rockvillesupport.com/rdm18-v2** to the owner's manual, and other important information you may need to get the most out of your item.

If you prefer written instructions, please read ahead!

With Rockville you get many options.



Missing items? If you ordered a bundle that includes more than one product and you are missing part of your bundle then it just means your order shipped from two different warehouses. You will receive the remaining items very soon. If you have any concerns or inquiries, feel free to call our customer support center at 1-646-758-0144, 24hours a day/7 days a week.

Rockwell

Thank you for purchasing this Rockville RDM18 Single Din receiver with Bluetooth, USB, SD, and AM/FM Radio. Please read this installation guide carefully for proper use of your RDM18. Should you need assistance, please call our technical help line at 1-646-758-0144, 24 hours a day/7 days a week.

TABLE OF CONTENTS

RECEIVER CONTROLS	4
RECEIVER FUNCTIONS	5
BLUETOOTH PAIRING	6
SETTING THE CLOCK	6
REMOTE CONTROL FUNCTIONS	6 - 7
INSTALLATION	8
WIRING	9
FEATURES	10
MAINTENANCE	11
INSTALLATION NOTES	11

RECEIVER CONTROLS

1. Power On-Off / Mute
2. Previous Track/Search Backwards/Browse Radio Stations
3. Volume/Select Knob
4. IR Receiver
5. USB Input Port
6. USB Charging Port
7. Aux-In Port
8. SD Card Slot
9. Preset 6/Skip Ahead 10/Lists and Menus in SD/USB Mode
10. Preset 5/Go Back 10/Lists and Menus in SD/USB Mode
11. Preset 4/Random Play
12. Preset 3/Repeat
13. Preset 2/Track Intro
14. Preset 1/Play/Pause
15. Mode/End Call
16. Automatic Music Search
17. Microphone
18. Reset Button
19. Next Track/Search Forward/Browse Radio Stations
20. Band Select/Answer Call

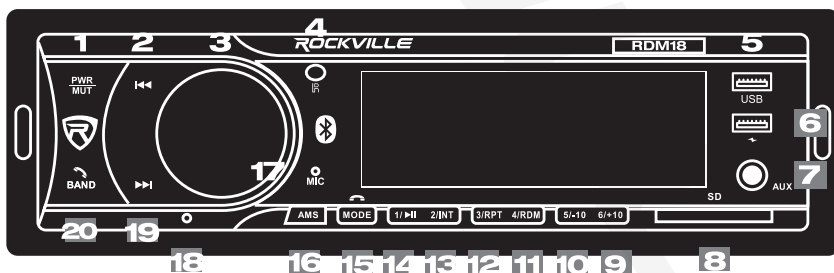

RECEIVER FUNCTIONS

Power ON-OFF/Mute Button: Press quickly to turn the unit on. Press for 3 seconds to turn the unit off. Press to mute the unit.

Mode Button: Press to cycle through playback modes in the following order: RADIO, USB, SD, AUX, BLUETOOTH. In Bluetooth mode, press to end calls.

AMS (Automatic Music Search) Button: In radio mode press to seek radio stations automatically. Press and hold to save desired station. In USB/SD mode pressing the AMS button will select the current song.

Band Button: In Radio mode press to cycle through bands in the following order: FM1, FM2, FM3, AM1, AM2. In Bluetooth mode press to answer calls.

◀◀▶▶ Buttons: In USB/SD mode press to return to a previous track or skip to the next track. In radio mode press to move backwards or forwards through stations.

1/▶▶ Button: In radio mode press to go to preset 1. In USB/SD mode press to play/pause music.

2/Int (Intro) Button: In radio mode press to go to preset 2. In USB/SD mode press to play snippet of each track. Press again to listen to full track. When in intro mode INT will be displayed on the screen.

3/Repeat Button: In radio mode press to go to preset 3. In USB/SD mode pressing this key will repeat the current track continuously. Press the button again to exit repeat mode. When in repeat mode RPT will be displayed on the screen.

4/Random Button: In radio mode press to go to preset 4. In USB/SD mode press this button to activate random playback mode. Press again to deactivate random mode. While in random mode RDM will be displayed on the screen.

5/-10 Button: In radio mode press to go to preset 5. In USB/SD mode press to choose next folder.

6/+10 Button: In radio mode press to go to preset 6. In USB/SD mode press to choose previous folder.

SD Card Slot: Insert SD card into slot and use the MODE button to cycle to SD mode. Audio playback will begin automatically. Supported file formats: MP3/WMA.

USB Port: Connect USB flash drive and use the MODE button to cycle to USB mode. Audio playback will begin automatically. Supported file formats: MP3/WMA.

USB Charging Port: Delivers 5V/0.5mA to charge your phone, MP3 player, etc.

Auxiliary In Port: Connect your external device (phone/MP3 player) via a 3.5mm to 3.5mm cable (not included).

Display Screen: The LCD screen will display relevant information about the current function.

Volume/Select Knob: Rotating the knob clockwise will increase the volume. Turning it counter clockwise will reduce the volume. Press the mode button and use knob to scroll through functions. Press down to select the desired function. Pressing down on the button will also allow you to adjust BASS, TREBLE, BALANCE, FADER, LOUD, and EQ settings.

Reset Button: Press this button to restore the unit to factory settings.

BLUETOOTH PARING

- Ensure that Bluetooth is enabled on your device.
- In the list of available Bluetooth connections, select “ROCKVILLE”.
- Your device should connect automatically.
- Some devices may require a password. If prompted, the password is 0000
- Please note only one phone can be paired to the unit at once. To pair another phone, please disconnect first unit.

SETTING THE CLOCK

- Press the Volume/Select knob to access volume menu.
- Press and hold the Volume/Select knob to access the clock edit screen. You should see the time.
- Press and hold the button again. The hour digits should start flashing.
- Turn the Volume/Select knob (forward or back) to adjust the hour. Once set, press the volume knob and the minute digits should start flashing. Turn the Volume/Select knob (forward or back) to adjust the minutes.
- When the correct time is set, press and hold the Volume/Select knob to save changes and exit the clock settings menu.

REMOTE CONTROL FUNCTIONS

1. Power
2. AMS (Automatic Music Search)
3. Mute
4. Band/Answer Calls
5. Increase Volume
6. Mode/End Calls
7. Previous Track/Browse Radio Stations
8. Select/Enter
9. Next Track/Browse Radio Stations
10. EQ Control
11. Decrease Volume
12. Clock Display/set clock
13. Preset 1/Play & Pause
14. Preset 2/Intro
15. Preset 3/Repeat
16. Preset 4/Random
17. Preset 5/Select Next Folder
18. Preset 6/Select Previous Folder
19. Loudness ON/OFF
20. LOC/DX
21. Scan Radio Stations

REMOTE CONTROL FUNCTIONS

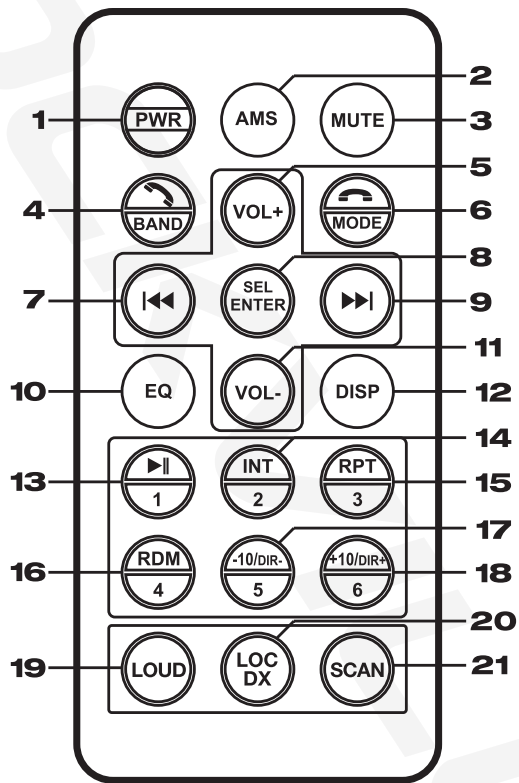

INSTALLATION

- Carefully remove the unit from the box. Keep the box for warranty and service purposes.
- Choose the mounting location carefully so that the unit will not interfere with normal driving functions.
- Avoid installing the unit where it will be subject to high temperatures from direct sunlight, heater vents; or where it would be subject to dust, dirt, or excessive vibration.
- If you have to do any modifications to the car body, such as drilling holes, consult your vehicle manual before doing so.
- To ensure a safe and secure installation we recommend you only use the included mounting hardware.
- Place the universal mounting bracket into the instrument panel.
- Use a screwdriver to bend mounting bracket stoppers if necessary.
- Insert the head unit into the universal mounting bracket until it locks.
- Securely fasten the trim plate.

Please note: it is recommended that you contact a professional to install the unit if you feel unsure or incapable of doing it yourself.

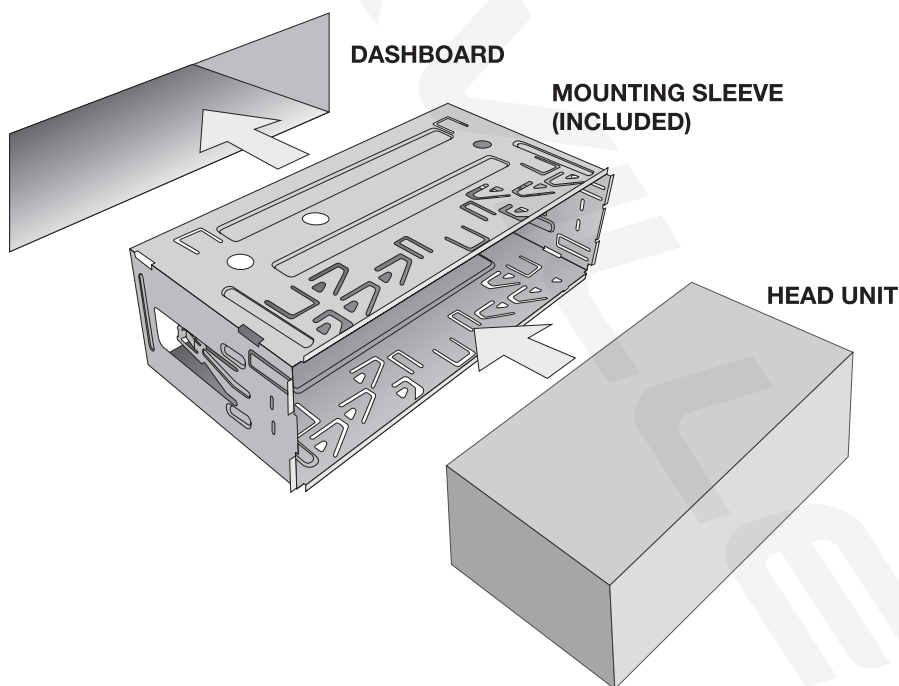

WIRING DIAGRAM

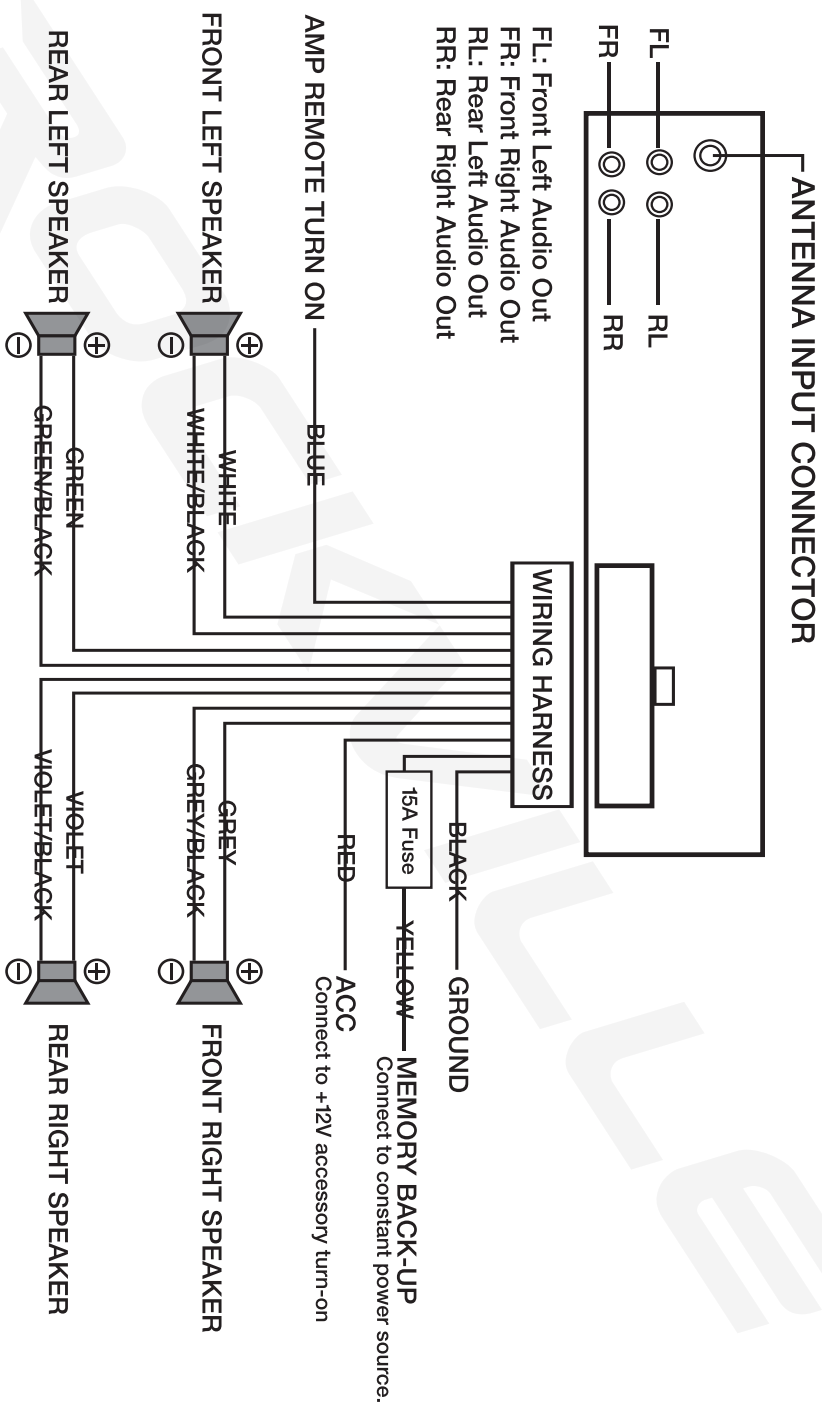

FEATURES

- Single DIN AM/FM Receiver
- Super Bright LCD Display
- SD Card Reader, Supports Double High Speed SDHC (32GB) Card
- USB 2.0 Input
- USB Charging Port (5V/0.5mA)
- Front 3.5mm AUX input
- Electronic PLL Tuning Control
- FM/AM Receiver w/18 FM and 12 AM Preset Station Capability
- Auto Memory Store/Preset Scan
- Automatic Music Search
- Repeat/Random/Intro Play Functions
- Preset and Custom EQ (Jazz/Pop/Rock/Classic/Loud/User)
- Mute/Loudness/Clock Function
- Power Output: 4 x 18W RMS/4 x 45W Peak
- 4 Channel RCA Output
- Pre-Amp Line-Out
- Bluetooth Capability for Hands-Free Calling and Streaming Music
- Built-in High Sensitivity BT Microphone
- Full-Function Remote Control Included

MAINTENANCE

FUSE REPLACEMENT: If the fuse blows, check the power connection and replace the fuse. If the fuse blows again, there may be an internal malfunction. In this case consult your local installer or call our technical help line at 1-646-758-0144, 24 hours a day/7 days a week.

FEDERAL COMMUNICATIONS COMMISSION COMPLIANCE INFORMATION

Responsible party name: Rockville

Address: 600 Bayview Ave.

Entrance A

Inwood, NY 11096

Hereby declares that the product RDM18 V2 complies with FCC rules as mentioned in the following paragraph:

This device complies with Part 15 of the FCC rules. Operation is subject to the following two conditions: (1) this device may not cause harmful interference, and (2) this device must accept any interference received, including interference that may cause undesired operation.

Note: This equipment has been tested and found to comply with the limits for a Class B digital device, pursuant to Part 15 of the FCC rules. These limits are designed to provide reasonable protection against harmful interference in a residential installation. This equipment generates, uses, and can radiate radio frequency energy and, if not installed and used in accordance with the instructions, may cause harmful interference to radio communications. However, there is no guarantee that interference will not occur in a particular installation. If this equipment does cause harmful interference to radio or television reception, which can be determined by turning the equipment off and on, the user is encouraged to try to correct the interference by one or more of the following measures:

- Reorient or relocate the receiving antenna.
- Increase the separation between the equipment and receiver.
- Connect the equipment to an outlet on a circuit different from that to which the receiver is connected.
- Consult the dealer or an experienced radio/TV technician for help.

Visit us at:

RockvilleAudio.com