

ROCKVILLE

RBG15FA/RBG18FA

ACTIVE POWERED PRO SUBWOOFER FOLDED
HORN PA/DJ SUB

OWNER'S MANUAL

ATTENTION:
WATCH THIS VIDEO BEFORE FIRST USE!

Who reads manuals?

Scan the **QR codes** or go to the **URLs** below to access the owner's manual, and other important information you may need to get the most out of your item.

If you prefer written instructions, please read ahead!

With Rockville you get many options.

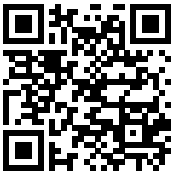

rockvillesupport.com/rbg15fa

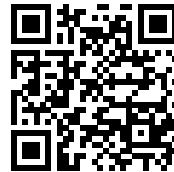

rockvillesupport.com/rbg18fa

Missing items? If you ordered a bundle that includes more than one product and you are missing part of your bundle, then it just means your order shipped from two different warehouses. You will receive the remaining items very soon. If you have any concerns or inquiries, feel free to call our customer support center at 1-646-758-0144, 24 hours a day/7 days a week.

ROCKWELL

Thank you for purchasing this Rockville Bass Gig series Folded Horn pro audio speaker. Please read this installation guide carefully for proper use of your folded horn speaker. Should you need assistance, please call our technical help line at 1-646-758-0144, 24 hours a day/7 days a week.

IMPORTANT SAFETY INSTRUCTIONS



- To reduce risk of electric shock, never open the unit. There are no user serviceable parts; refer service to the Rockville service center.
- Do not expose this unit to any kind of moisture.
- Unit should be situated away from heat sources.
- Do not obstruct vents or exhaust fan.
- Please ensure that the unit is situated in a properly ventilated area.
- Make sure the unit is placed on a level and stable surface. This unit should not be mounted to a wall or ceiling.
- If this product is equipped with a polarized alternating current line plug (a plug having one blade wider than the other), it will fit into the outlet only one way. This is a safety feature. If you are unable to insert the plug fully into the outlet, try reversing the plug. If the plug should still fail to fit, contact your electrician to replace your obsolete outlet.
- If this product is equipped with a three-wire grounding-type plug, a plug having a third (grounding) pin, it will only fit into a grounding-type power outlet. This is a safety feature. If you are unable to insert the plug into the outlet, contact your electrician to replace your obsolete outlet.

What is a Folded Horn woofer ask?

Any horn shape which gradually expands from a small inlet to a large opening will act as a physical amplifier for sound applied to the smaller end. When coupled to a loudspeaker it improves its efficiency, but a full-size horn that would work at low frequencies would make for an impractically large cabinet. By folding the horn back on itself, you can significantly reduce its size, without compromising the effect. When this technique is used to take energy from the back of a speaker and redirect it to the front, you have a folded horn bass reflex cabinet. Below is an example of a basic folded horn design.

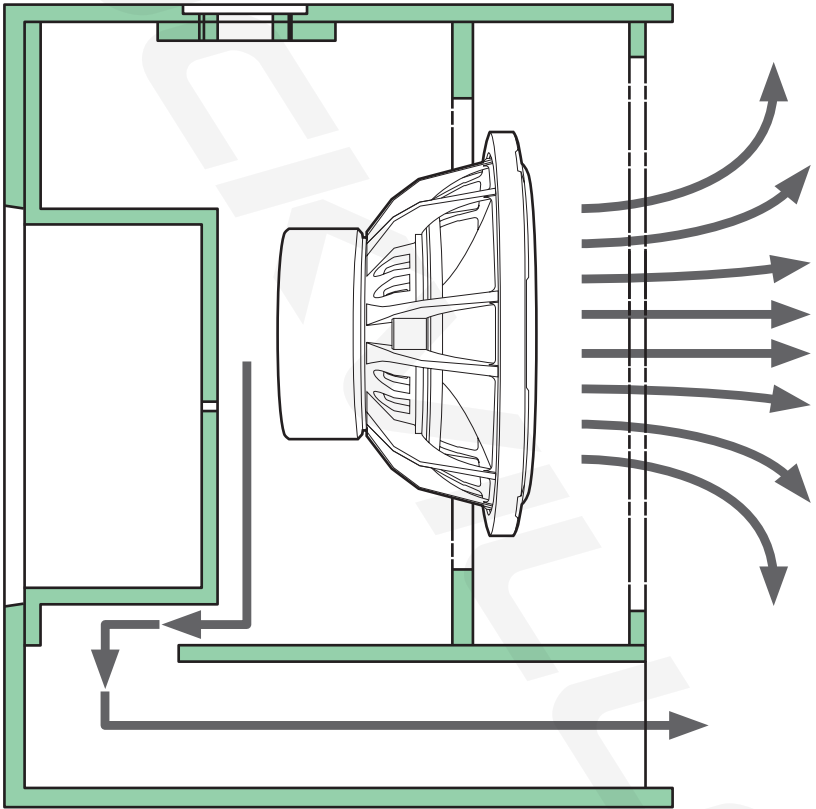

Folded Horn Subwoofer with Two Sound Reinforcement Speakers in Full Range Configuration

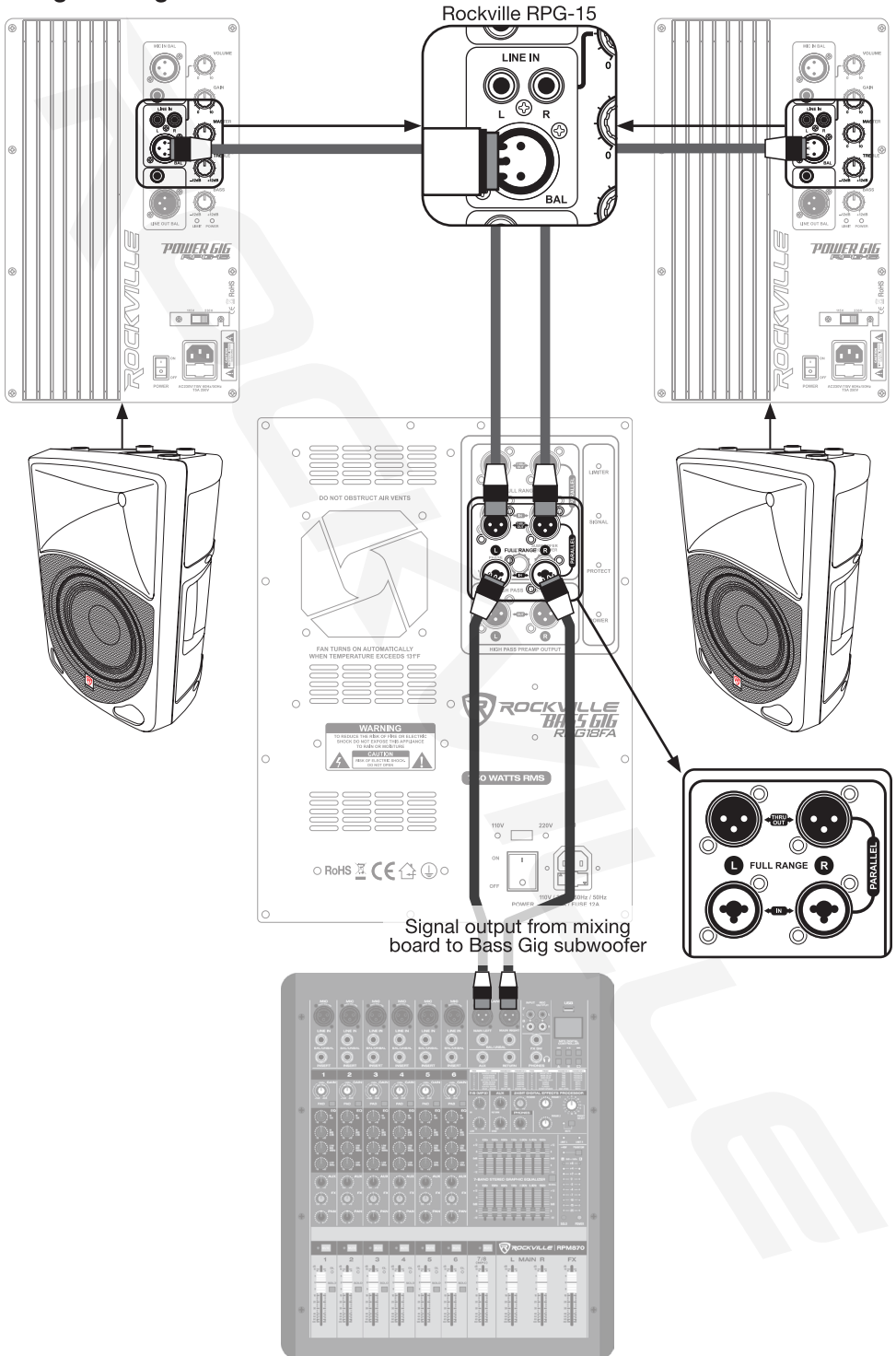

Folded Horn with Two Sound Reinforcement Speakers in a High Pass Configuration

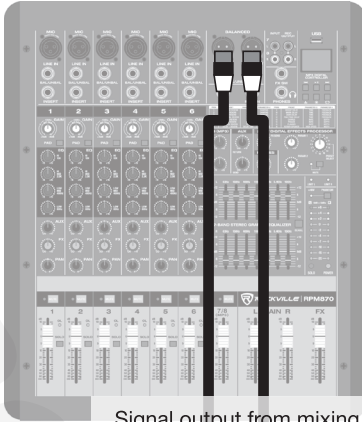

Signal output from mixing board to Bass Gig subwoofer

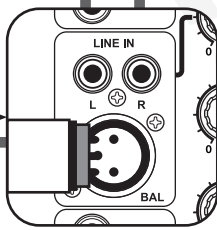
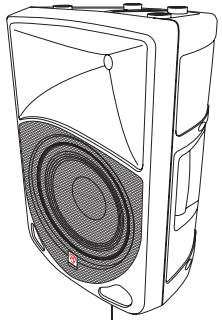
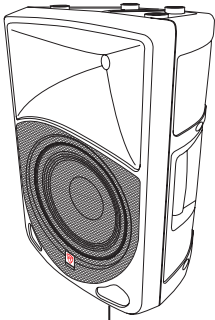
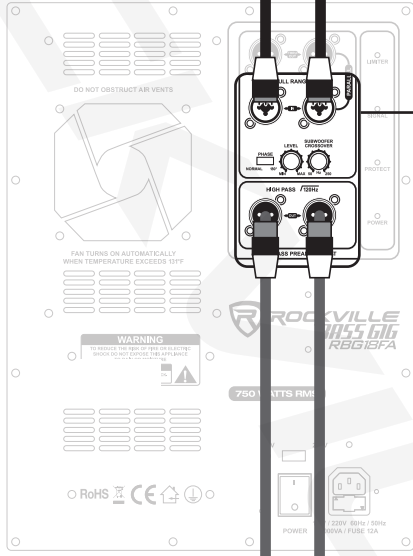
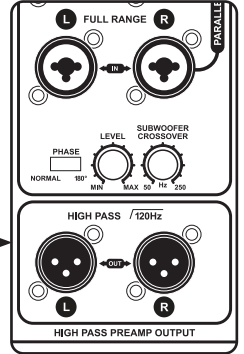

Rockville RPG-15

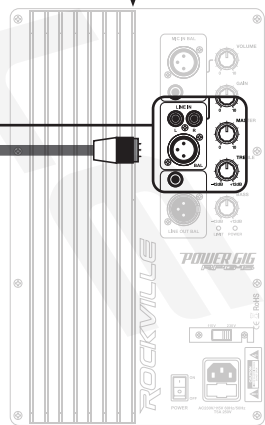
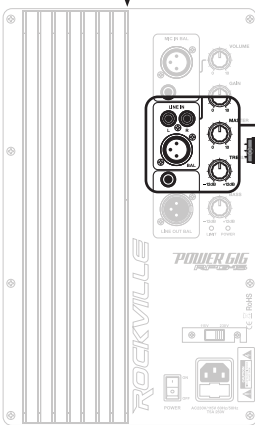

Folded Horn w/Dual Speaker Configuration

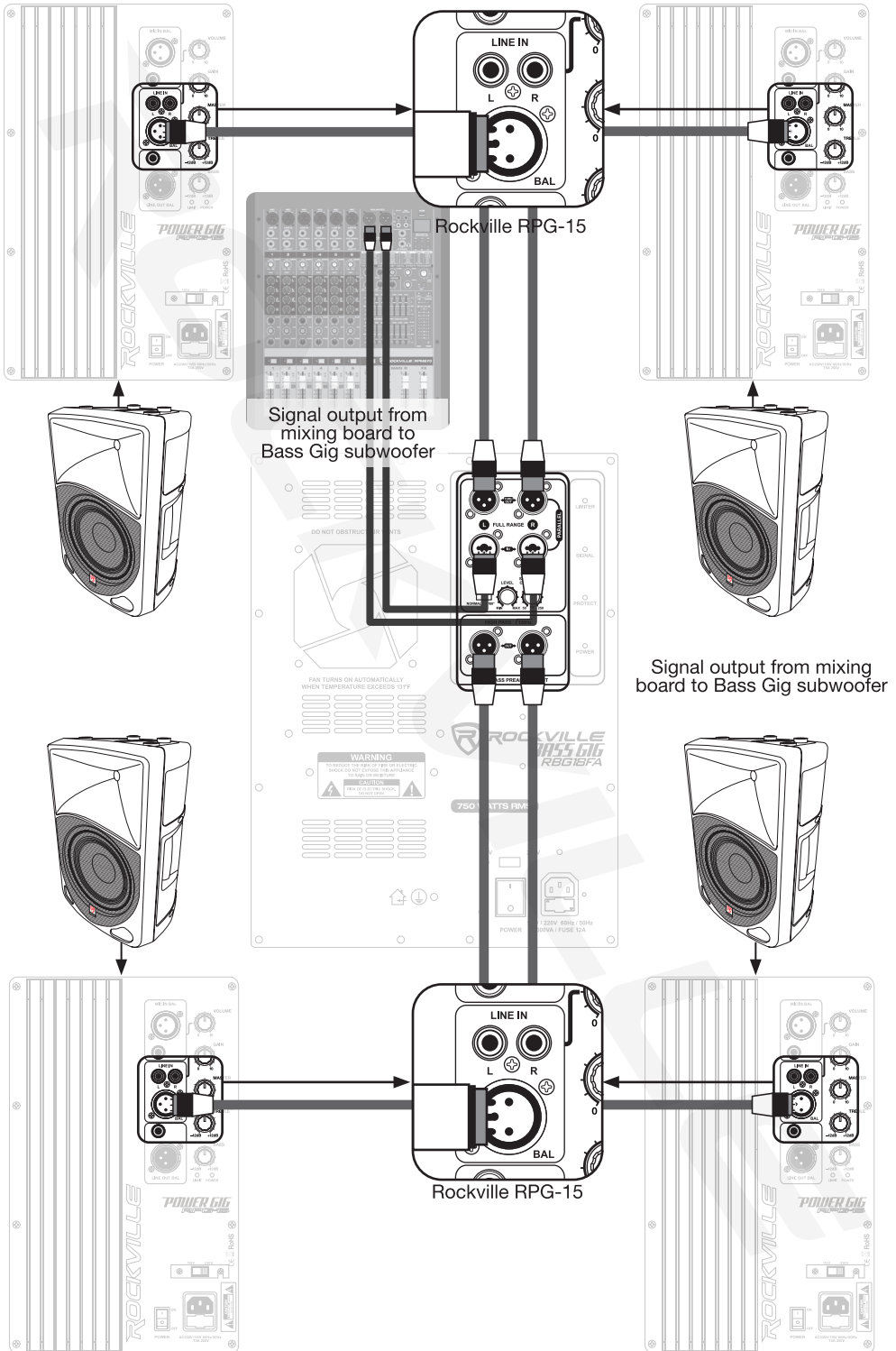

Balanced vs Unbalanced Lines

A balanced line is a three-conductor system in which two signal wires carry an equal but opposite voltage with respect to the ground wire. The ground wire acts only as a shield and does not carry any audio signal current. Outside interference is either shielded from the internal signal conductor, or if it gets into the cable is cancelled out by the opposite signals at the receiving end. Balanced connections are preferred for long cable runs.



An unbalanced cable is a two-wire system where the shield (ground wire) acts as one of the current-carrying signal conductors. The center conductor enclosed by the shield is commonly known as the “hot” conductor. Unbalanced audio cables do not reject noise as well as balanced lines. Unbalanced lines are typical in home hi-fi-type systems and on the outputs of electronic musical instruments. These work well if the distance between the components is short, the signal level is relatively, high and all of the electronics used in the system are plugged into the same AC outlet.



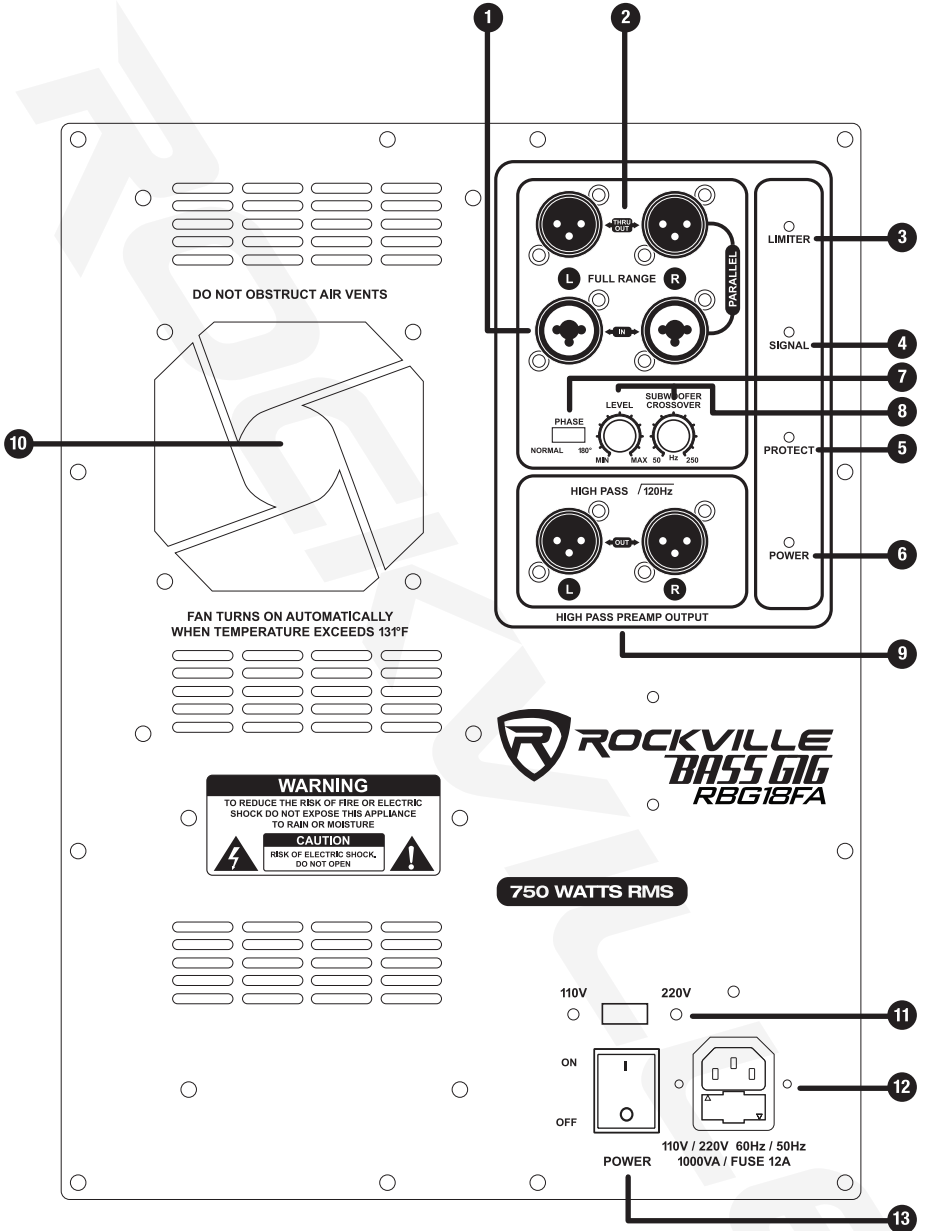

1. Full-range XLR/¼" combo jack input will accept line input signal from any line-level device with a balanced output jack.
2. Full-range parallel XLR thru/output jacks will send the signal from the full-range combo inputs to another device.
3. Amplifier clip limit LED indicator. Lights up when the amplifier is near clipping. An occasional flickering is acceptable. If LED is lit continuously, adjust the level control and reduce the output level of connected sources. Failure to do so may lead to premature failure of your speaker.
4. Full-range signal LED indicator. Indicates signal input from connected sources.
5. Protect mode LED indicator. Indicates when amplifier has entered into protect mode.
6. Power LED indicator.
7. The Phase Shift switch synchronizes the phase of your subwoofer output to that of the other speakers in the vehicle. It can be set to NORMAL or 180 degrees. Set the switch to NORMAL and listen to a track with some bass. Now set the switch to 180 degrees, listen to the same track, and see if the bass output improves or becomes worse. Set the switch to the setting that achieves the best results.
8. The level knob is used to regulate the output level of the subwoofer. It allows you to set the balance between the speakers and subwoofers. The subwoofer crossover knob allows you to set the crossover frequency and will attenuate frequencies below that setting.
9. High-Pass Pre-Amp XLR outputs are used to send the incoming signal to a full-range active speaker or power amp. These outputs have a set default crossover of 120Hz, so frequencies below that do not play.
10. Heat-sensitive, variable-speed, auto-turn-on fan. Fan activates when temperature reaches 131° Fahrenheit. Speed is automatically adjusted as temperature increases or decreases.
11. Variable voltage selector switch. Allows user to switch between 110v and 220v.
12. IEC AC power socket/user serviceable fuse compartment.
13. Power switch.

Specifications

RBG15FA

- 600 Watts RMS/1200 Watts Program/2400 Watts Peak
- 15" Woofer with 110oz Magnet and 4" Voice Coil
- Frequency Response: (± 3 dB) 30Hz – 120Hz
- Maximum SPL @ 1w/1m: 130dB Peak/127dB Continuous

Specifications

RBG18FA

- 750 Watts RMS/1500 Watts Program/3000 Watts Peak
- 18" Woofer with 130oz Magnet and 4" Voice Coil
- Frequency Response: (± 3 dB) 25Hz – 120Hz
- Maximum SPL @ 1w/1m: 135dB Peak/129dB Continuous

Features

RBG15FA/RBG18FA

- Folded horn design powered subwoofer
- Power-On, Protect, and Signal Input LED Indicators
- Clip Limiter Circuitry with LED Indicator
- Balanced XLR input
- Balanced XLR thru/output jacks for parallel connections
- Passive heat sink with heat-sensitive, variable-speed, auto-turn-on fan for cooling
- Subwoofer Crossover 50Hz – 250Hz Low Pass
- Subwoofer Level Adjustment
- Subwoofer Phase Control
- Built-in XLR Balanced High-Pass Preamp Output @ 120Hz Crossover
- Variable voltage (110v/220v)
- Built-in pole mount socket
- Built-in carrying handles
- Heavy-duty 2" (RBG-15FA)/3" (RBG-18FA) locking caster wheels
- High-density MDF construction
- Fuse rating: 1000VA/12A
- Dimensions: RBG-15FA: 23.7" x 17.2" x 23.5"/RBG18FA: 35.4" x 28.7" x 29.1"
- Weight: RBG-15FA: 83Lbs/RBG-18FA: 130Lbs

Fuse Replacement Diagram

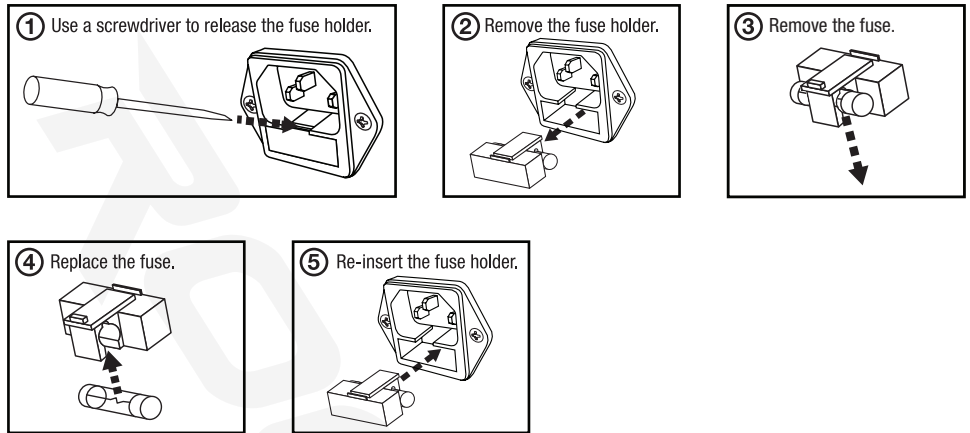

How to Switch Voltage

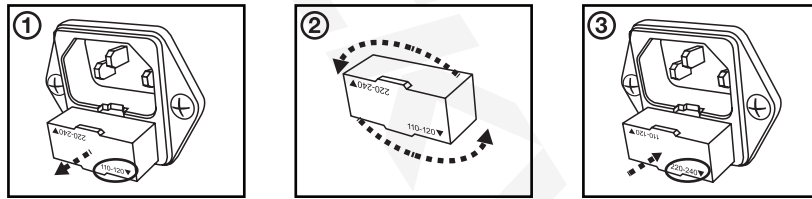

Troubleshooting

PROBLEM	SOLUTION
No power	<ol style="list-style-type: none"> 1. Make sure the unit is plugged in and the power switch is in the ON position. 2. Check that the power cable is plugged in tightly to the unit. 3. Check and replace the fuse if necessary. See fuse replacement diagram above. 4. If people or equipment tend to step on, roll over or stretch your power cable it can get damaged. Always try a second cable to test for shorts in original cable. Dispose of original damaged power cables immediately.
No sound/ distorted sound	<ol style="list-style-type: none"> 1. Check that all appropriate cables are plugged in correctly. 2. Check the Output Level and Subwoofer Crossover settings. 3. If using a mixing console, make sure fader and balance are set to center positions and levels are increased.
Buzzing sound	Check the requirements of the connected gear and the input of the speaker and make sure you are using the appropriate cable.

FEDERAL COMMUNICATIONS COMMISSION COMPLIANCE INFORMATION

Responsible party name: Rockville

Address: 600 Bayview Ave.
Entrance A
Inwood, NY 11096

Hereby declares that the product(s) RBG-FA series pro audio folded horn speakers comply with FCC rules as mentioned in the following paragraph:

This device complies with Part 15 of the FCC rules. Operation is subject to the following two conditions: (1) this device may not cause harmful interference, and (2) this device must accept any interference received, including interference that may cause undesired operation.

Note: This equipment has been tested and found to comply with the limits for a Class B digital device, pursuant to Part 15 of the FCC rules. These limits are designed to provide reasonable protection against harmful interference in a residential installation. This equipment generates, uses, and can radiate radio frequency energy and, if not installed and used in accordance with the instructions, may cause harmful interference to radio communications. However, there is no guarantee that interference will not occur in a particular installation. If this equipment does cause harmful interference to radio or television reception, which can be determined by turning the equipment off and on, the user is encouraged to try to correct the interference by one or more of the following measures:

- Reorient or relocate the receiving antenna.
- Increase the separation between the equipment and receiver.
- Connect the equipment to an outlet on a circuit different from that to which the receiver is connected.
- Consult the dealer or an experienced radio/TV technician for help.

ROCKWELL

ROCKWELL

ROCKVILLE

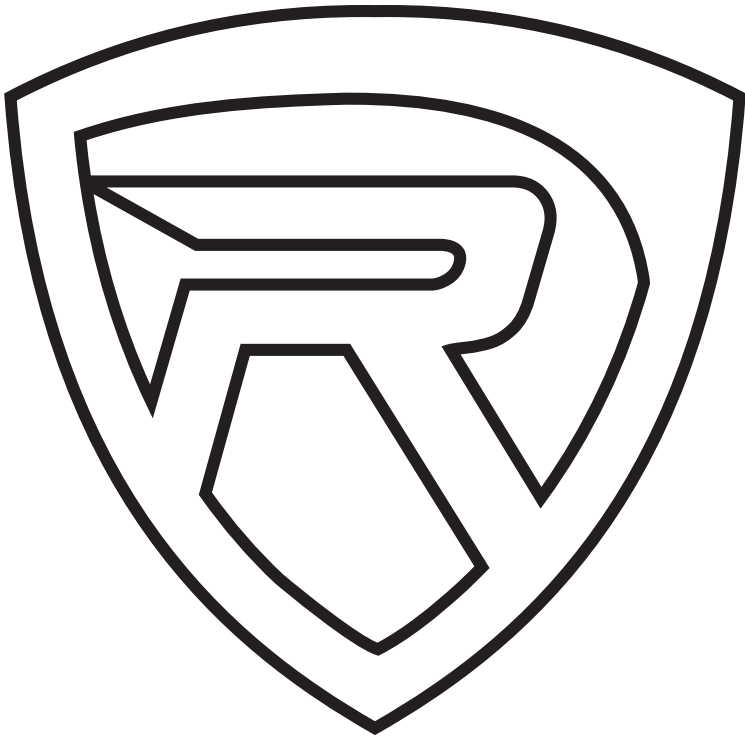

RockvilleAudio.com

© 2022 ROCKVILLE // Features and specifications are subject to change and/or improvement without notice.