

ROCKVILLE

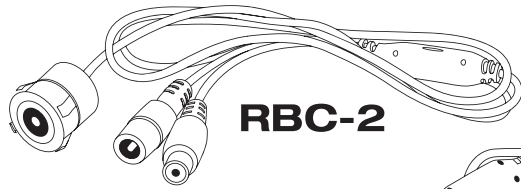

RBC-2

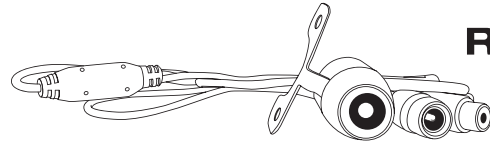

RBC-3

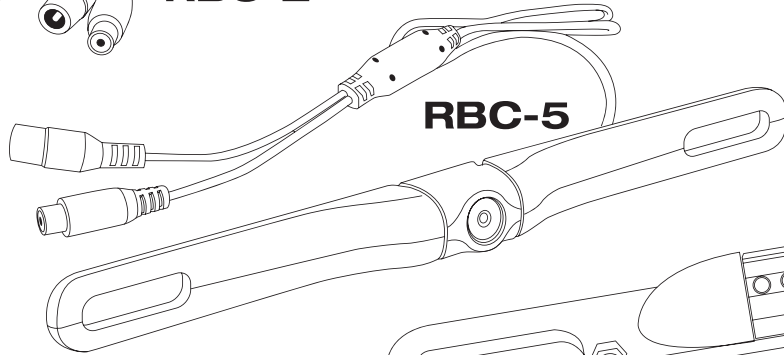

RBC-5

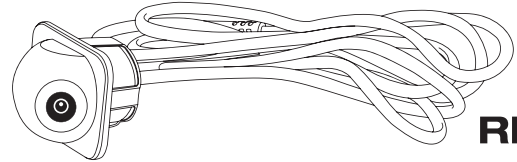

RBC-4

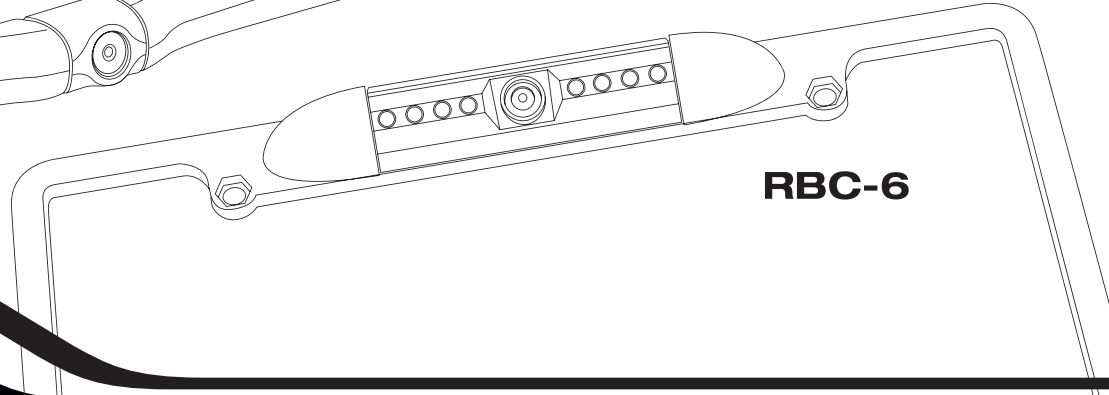

RBC-6



RBC SERIES

REARVIEW BACK-UP CAMERAS OWNER'S MANUAL

WIRING DIAGRAM (RBC-2 shown, wiring procedure is the same for all cameras)

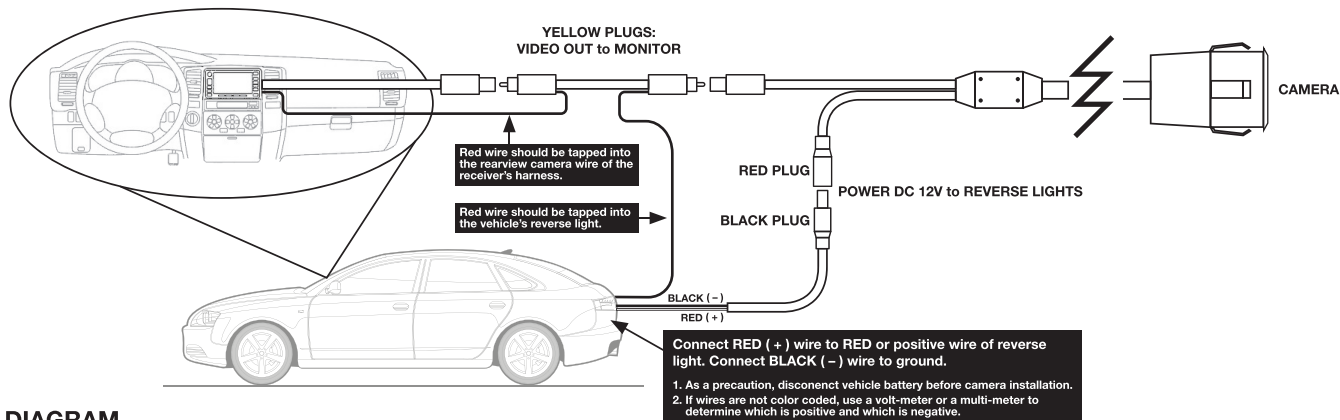

MOUNTING DIAGRAM

BUTTERFLY BRACKET MOUNT

1. Drill two holes into vehicle exterior at desired installation area.
2. Use screws provided to secure camera to vehicle exterior.
3. Insert camera cable through secondary hole.

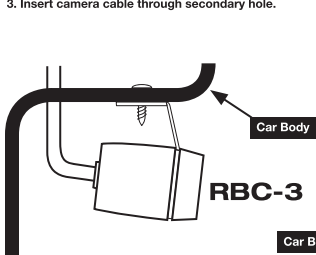

FLUSH MOUNT A

1. Drill proper size hole (18.5mm) into vehicle rear bumper.
2. Insert camera through the hole from the exterior of the vehicle.

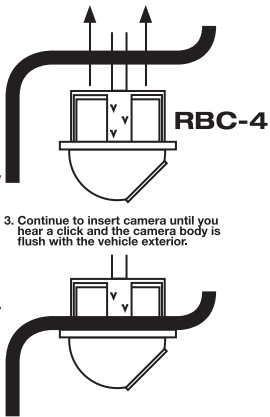

FLUSH MOUNT B

1. Drill proper size hole (18.5mm) into vehicle rear bumper. Optional Butterfly Bracket Mount included. Follow Butterfly Bracket Mount directions.
2. Insert camera through the hole from the exterior of the vehicle.

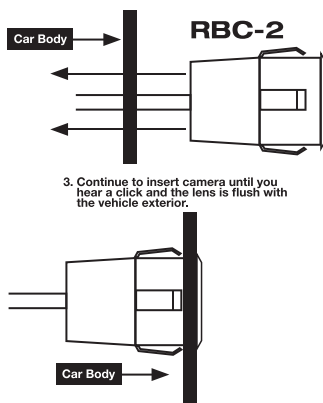

LICENSE PLATE MOUNT

1. Drill proper size hole into vehicle rear bumper for camera cables.
2. Remove license plate top screws. Attach camera to license plate using provided screws.

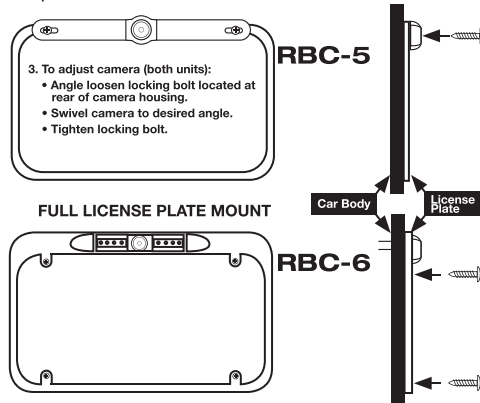

FEATURES

- Waterproof and Fog Resistant
- Easy Installation
- Auto Turn-On
- True Color Reproduction
- Automatic White Balance
- Guidance Distance Grid
- Includes: DC Power Cable, RCA Video Control Cable, Mounting Screws

SPECIFICATIONS

- NIGHT VISION IMAGE SENSORS: PC6070
- POWER SUPPLY: DC9V - 15V
- LENS ANGLE: 170°
- TV SYSTEM: PAL/NTSC
- VIDEO OUTPUT: 1.0vp-p,75ohm
- S/N RATIO: ≥48dB
- IP RATING: Ip67
- OPERATING TEMPERATURE: -22°F - 158°F
- RELATIVE HUMIDITY: 95% Max.
- WHITE BALANCE: Auto
- MINIMUM ILLUMINATION: 0.0 to 0.1Lux (depending on model)
- AGC: Auto
- ELECTRONIC SHUTTER: 1/60(NTSC) 1/50(PAL), 1/10,000second
- EFFECTIVE PIXELS: 648H x 488V
- RESOLUTION (TV LINES): 420

TROUBLESHOOTING

NO IMAGE: Check that POWER cable is connected properly.

Check that VIDEO cable is connected properly

Make sure vehicle is in reverse.

Make sure monitor is properly installed.

IMAGE BLURRING: Make sure CAMERA LENS is clean.

IMAGE SHAKING: Make sure MOUNTING SCREWS are tight.

IMAGE SLANTING: Adjust CAMERA ANGLE.

Never attempt to disassemble camera as there are no user serviceable parts.

Should you need assistance, please call our technical help line at 1-646-758-0144, Monday through Friday, 9am to 5pm EST.

ROCKVILLE

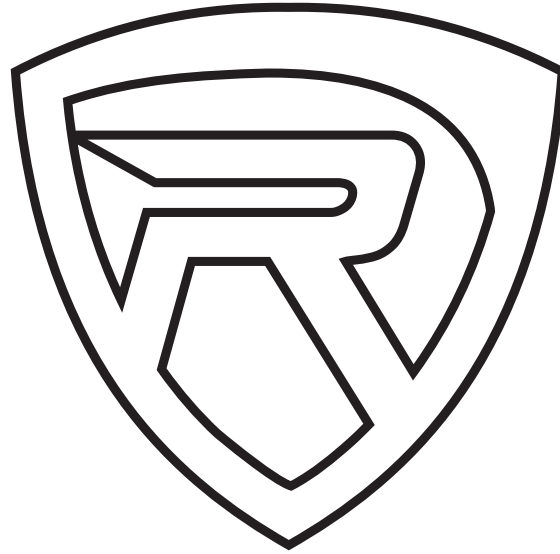

RockvilleAudio.com

© 2020 ROCKVILLE // Features and specifications are subject to change and or improvement without notice.