

ROCKVILLE

ROCKVILLE

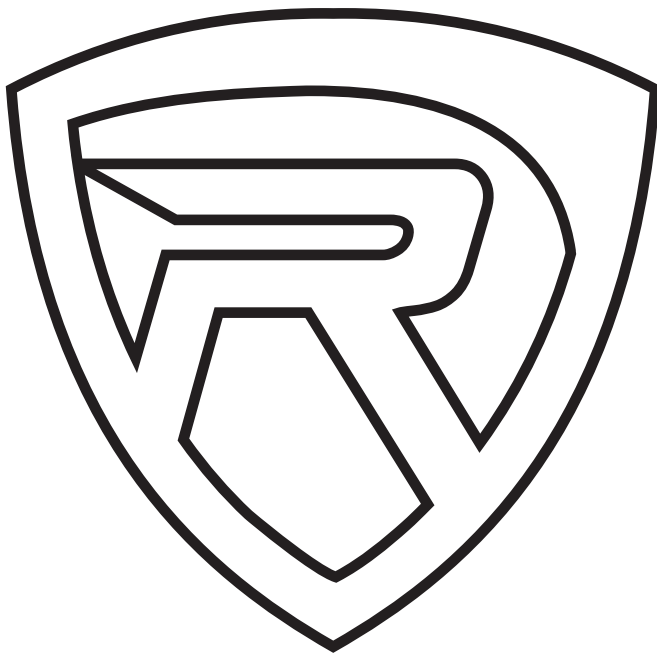

RockvilleAudio.com

© 2018 ROCKVILLE // Features and specifications are subject to change and or improvement without notice



OWNER'S MANUAL
MS10L/MS12L
Marine/Boat Subwoofer with LEDs

The Rockville MS-L series marine subwoofer is one of the most powerful on the market. What really makes this sub stand out is the sound quality and durability. The frequency range of these subs is so good that it will make all your songs sound so much better! These play frequencies that normal full range speakers cannot hit adding depth and richness to all your music. We added an awesome LED lighting effect to these subs to really make your system shine. The MS-L series subwoofer was designed in a molded ABS plastic basket made with a special blend that is waterproof and unbreakable. You can literally jump on it and hit it with a sledgehammer without it breaking!

Using only true marine grade components and materials, the Rockville MS-L series subwoofers are fully marinated against salt & fresh water conditions. These subs are completely waterproof and protected from the elements! They are UV treated and have a special waterproof coating to prevent water damage.

Please read this guide carefully for proper use of your Rockville MS-L series marine subwoofer. Should you need technical assistance please call our technical help line at 1-646-758-0144, Monday through Friday, 9am to 5pm EST.

Features/Specifications

MS10L

- Max power: 2400 Watts
- RMS program power: 1200 Watts
- RMS power: 600 Watts
- Polypropylene cone with rubber edge
- 2.0" 4 Layer dual voice coil
- Molded ABS plastic basket made with a special blend that is water proof and unbreakable
- Cool LED lighting effect
- Magnet 80oz double stacked magnet
- Frequency response: 30Hz – 4Khz
- Impedance: Dual 4 ohms
- Sensitivity: 90dB
- Total diameter: 10.55"
- Cutout diameter: 9.0"
- Mounting depth: 5.6"

MS12L

- Max power: 2800 Watts
- RMS program power: 1400 Watts
- RMS power: 700 Watts
- Polypropylene cone with rubber edge
- 2.0" 4 Layer dual voice coil
- Molded ABS plastic basket made with a special blend that is water proof and unbreakable
- Cool LED lighting effect
- Magnet 100oz double stacked magnet
- Frequency response: 20Hz – 4Khz
- Impedance: Dual 4 ohms
- Sensitivity: 90dB
- Total diameter: 12.8"
- Cutout diameter: 11"
- Mounting depth: 6.1"

Installation

1. Find a mounting location that does not interfere with the safe operation of your vessel. Make sure mounting screws will not puncture wiring harnesses, control cables, hydraulic lines, fuel lines, the fuel tank or the hull. These may be located behind or under the mounting surface.

2. Create a mounting template using the provided measurements and place it on the desired surface. Using a jigsaw or rotary cutting tool, cut along the line denoting the mounting hole. Use a drill to drill the holes for the mounting screws.

3. Remove the grill. Connect your pre-routed speaker cables to the woofer. Insert the woofer into the mounting hole, align the mounting screw holes, insert the screws and tighten them. Be sure to not over tighten. To replace the grill, press and turn clockwise (to the right).

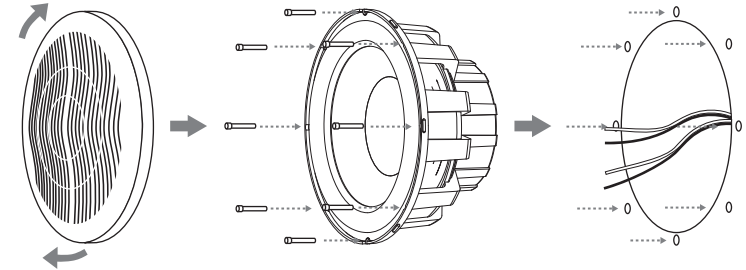

Connection Diagram

One 4 ohm DVC woofer with a 2 ohm load

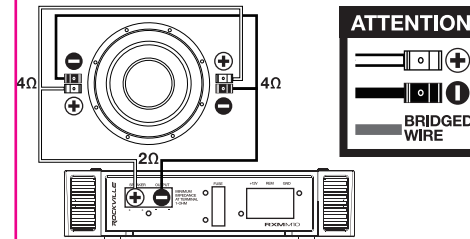

One 4 ohm DVC woofer with an 8 ohm load

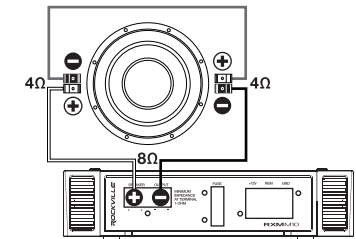

Two 4 ohm DVC woofers with a 1 ohm load

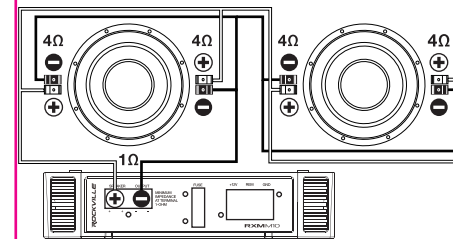

Two 4 ohm DVC woofers with a 4 ohm load

