

## Dimensions

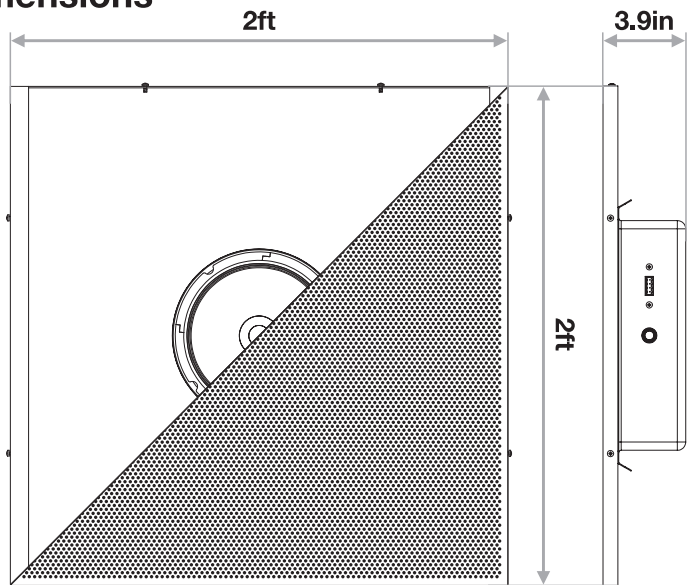

## Features/Specifications

- Built-in 8" highly efficient speaker pre-mounted into a ceiling tile
- Easy installation fits perfectly into 2ft x 2ft standard-sized US drop ceilings. Simply drop it in and connect the speaker wire
- Metal grill
- Works for both 70 volt and 100 volt operation or even 8 ohm
- Multi-tap options:
  - 70V: 10w, 5w, 2.5w, 1.5w
  - 100V: 10w, 5w, 2.5w
- 8 Ohm power handling: 30W RMS
- 30 Watts RMS power handling at 8 ohms
- Low profile mounting depth (3.9")
- European-style terminal block (Euroblock)
- Sensitivity: 91dB
- Designed to sound great for speeches, announcements, music, and chimes
- 105° dispersion pattern
- Extremely efficient paper cone
- 1" Voice coil
- Aluminum former
- 10oz. Ferrite Magnet
- High temperature copper voice coil windings
- Frequency Response (-10 dB): 170Hz – 17kHz
- Dimensions in inches: 23.8" x 23.8" x 3.9"
- Weight: 13.7Lbs

# ROCKVILLE



## OWNER'S MANUAL

### DCS8T

70V Commercial 8" Drop Ceiling Tile Speaker

**RockvilleAudio.com**

© 2020 ROCKVILLE // Features and specifications are subject to change and or improvement without notice

The Rockville DCS8T is a great choice for any restaurant, office, school, retail store, or other commercial application. This speaker will sound great for all your PA announcements and background music. Please read this guide carefully for proper use of your DCS8T series commercial in-ceiling speakers. Should you need technical assistance please call our technical help line at 1-646-758-0144, Monday through Friday, 9am to 5pm EST.

## Functions

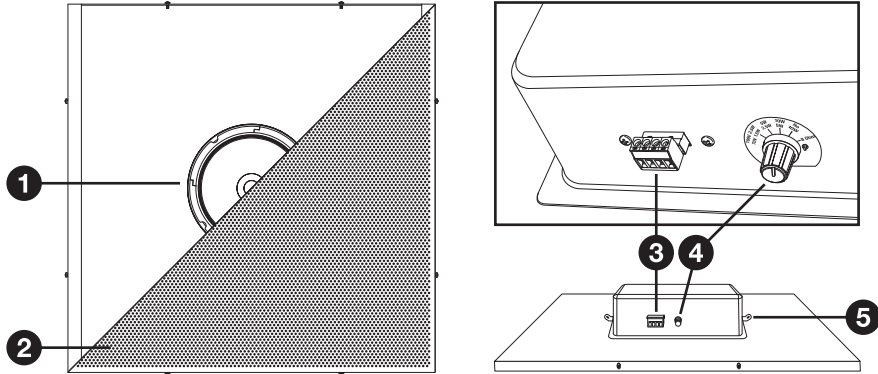

1. Full range speaker
2. Metal grill
3. European-style terminal block (euroblock)
4. 70V/100V/8-Ohm Tap Switch
5. Safety hook: Used to attach a safety strap to secure the speaker to the ceiling.

## Choosing the Appropriate Tap

70-volt systems are the number one choice for any application where you want to install multiple speakers. With 70 volt there are a lot of advantages over 8-ohm systems. One of the main advantages is the simplicity of the wiring as well as how easy it is to match up the speakers with an amplifier. You always want your 70-volt amp to have at least 15 or 20% more power than the combined watts your speakers are tapped at. For example, if you have a 180-watt/70-volt amplifier, you can install ten 70-volt speakers that are tapped at 15 watts each or twenty-five 70-volt speakers that are tapped at 5 watts each as long as they total close to 150 watts. When we say the word tap, what we are referring to is the selector knob on the control panel of the DCS8T speakers. It allows you to set how many watts the built-in transformer will allow the speaker to get from the amplifier. The taps set at 1.5, 2.5, 5, and 10 watts for 70-volt input and 2.5, 5, and 10 watts for 100-volt input. This range of taps allows for full customization of the sound for the space in which the speakers are installed. In a restaurant, for example, you can tap your dining room speakers at 5 watts, the speakers in the outside seating area at 10 watts, the ones in the hallway at 2.5 watts, and the speakers in the bathrooms at 5 watts. Another great feature of 70-volt speakers is that you can mix and match any type whether they are ceiling speakers (such as these), wall mounted speakers, subwoofers, etc.

Another benefit of 70-volt speaker set-ups is the ability to run very long lines of speaker wire without signal loss. And, the wiring is very simple. You just connect all the positive terminals of the speakers to the positive 70-volt terminal(s) of the amplifier. The negative terminals on the speaker get connected to the negative (COM) terminal(s) of the amp. You do not have to worry about impedance as the power is constant.

Please be sure to check out Rockville's complete selection of high-quality, 70-volt speakers, amplifiers, and accessories.

## Setup

### 70V/100V Speaker Configuration.

The total number of speakers multiplied by the tap value cannot exceed the output power (in watts) of your 70V/100V amplifier. The example on the facing page shows 4 total speakers. Using the 10W taps, you will need an amplifier with at least 40 watts ( $4 \times 10 = 40W$ ). A good rule of thumb is to select an amplifier with 15 to 20% greater power; in this case, an amplifier that delivers about 50W.

## Setup (continued)

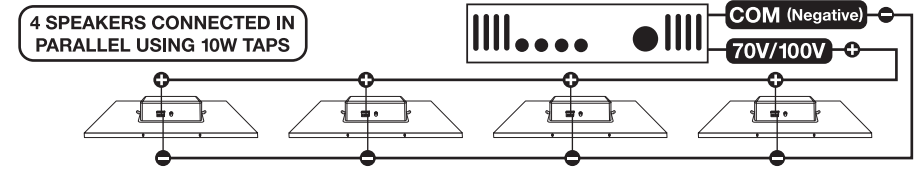

### 8-Ohm Speaker Configuration

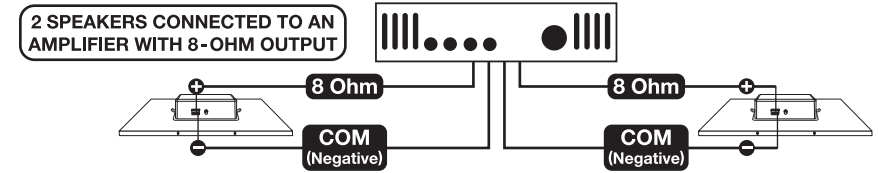

## Installation

Tools needed: Drywall knife, wire strippers, tape measure, ladder  
2ft x 2ft Drop Ceiling Tile

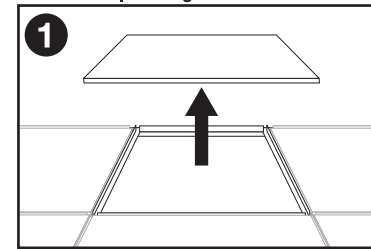

Remove the existing tile.

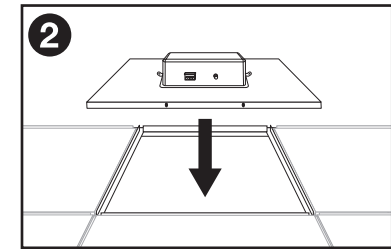

Carefully drop in the DCS8T speaker, ensuring that it is properly seated on the ceiling grid.

### 2ft x 4ft Drop Ceiling Tile

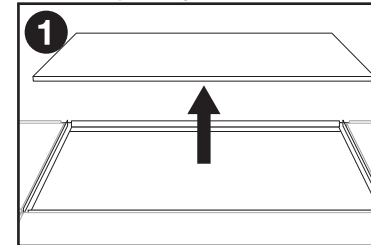

Remove the existing tile. Measure it, then cut it in half.

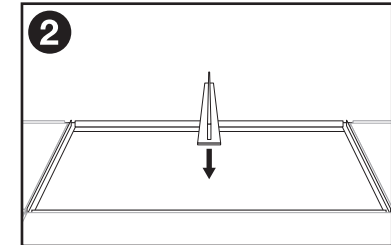

Insert a support rail (not included) in the center of the space.

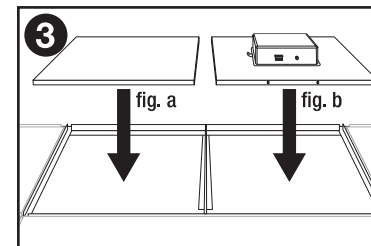

Place the cut half of the 2ft x 4ft ceiling tile on one side of the opening (fig. a) and the DCS8T speaker on the other half (fig. b). Make sure that both are properly seated on the ceiling grid.

## Wiring

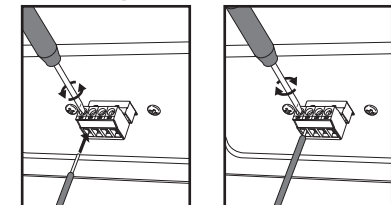

Use a small flathead screwdriver to loosen the terminal screw (fig. a). Strip 0.50" of sheathing from the speaker wire. Insert the wire into the terminal (fig. b) and tighten the screw (fig. c).