

ROCKVILLE ROCK SLIM 70

Owner's Manual

WHO READS MANUALS?

Scan the QR codes or go to the URLs to access how-to video(s), the owner's manual, and other important information you may need to get the most out of your item.



rockvillesupport.com/rock-slim-70b



rockvillesupport.com/rock-slim-70w

Thank you for purchasing this Rockville ROCK SLIM 70 5.25" super thin 70 volt commercial wall mount speakers. Please read this owner's manual carefully for proper use. Should you need assistance, please call our technical help line at 1-646-758-0144, 24 hours a day/7 days a week.

IMPORTANT SAFETY INSTRUCTIONS

1. When the speakers are mounted on the wall, make sure the wall structure is reliable and the speakers are firmly attached.
2. Install the speaker in a location that can structurally support the weight of the speaker and its mounting hardware. Otherwise it may result in the unit falling down and possibly causing personal injury.
3. Do not use nails, adhesives or other unauthorized devices. Long-term use and vibrations may cause it to fall easily.
4. Do not touch or bump woofer and tweeter. If these are damaged, the sound will be distorted.
5. Make sure the volume is turned down when you are installing/removing cables or changin the input source. Failing to do so may cause damage to the speaker.

FEATURES AND SPECIFICATIONS

- Pair of Rockville ROCK SLIM 70 70 Volt Commercial Speakers
- Built in 70 Volt transformer with Inputs for 8 watts or 4 watts
- Easy wall mount brackets
- 5.25" Woofer with Paper Cone has Natural Sound Reproduction with Clear Mids and Bass
- Two separate input terminals allow you to select 4 watts or 8 watts (70 volt)
- 0.5" Mylar dome tweeter delivers pristine highs
- Sensitivity: 89 dB
- Frequency Response ($\pm 3\text{db}$): 100Hz - 20kHz
- Cabinet Material: ABS
- Shielded grill offers additional protection from dust and damage
- Hanging bracket is molded into the speaker
- Recessed spring-loaded speaker wire terminals make it easy to hide wires
- Molded speaker wire groove makes it easy to run speaker wires behind the speaker
- Beautiful sleek design is perfect for a living room, bedroom, kitchen, restaurant, and more
- Color: Available in White or Black
- Product Dimensions: 10.8" x 7.3" x 1.38" inches
- Product Weight: 2 Lbs. (Per Speaker)

CHOOSING THE APPROPRIATE TAP

The taps are the three spring loaded push terminals at the rear of the speakers, one black and two red. The two red terminals allow for either 4 watts or 8 watts for **70-volt input only**. This range allows for full customization of the sound for the space in which the speakers are installed. In a restaurant, for example, you can tap your dining room, hallway, and bathroom speakers at 4 watts, then the speakers in the outside seating area can be set at 8 watts. Another feature of 70-volt speakers is that you can mix and match any type whether they are wall mounted speakers (such as these), in-ceiling speakers, subwoofers, etc.

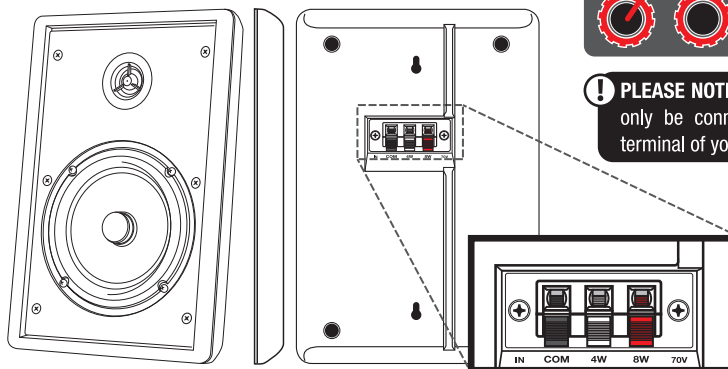

WIRING

70-volt speaker set-ups allow you to run very long lines of speaker wire without signal loss. Wire the specific (4w or 8w) positive terminals of the speakers to the positive **70-volt terminal of the amplifier only**. The negative terminals on the speaker simply get wired to the negative terminal on the amp. You do not have to worry about impedance, the power is constant.

The total number of speakers multiplied by the tap value cannot exceed the output power (in watts) of your 70V amplifier. The example below shows 12 total speakers. Using the 8W taps, you will need an amplifier with at least 100 watts ($12 \times 8 = 96\text{W}$). A good rule of thumb is to select an amplifier with 15 to 20% greater power; in this case, an amplifier that delivers about 120W.

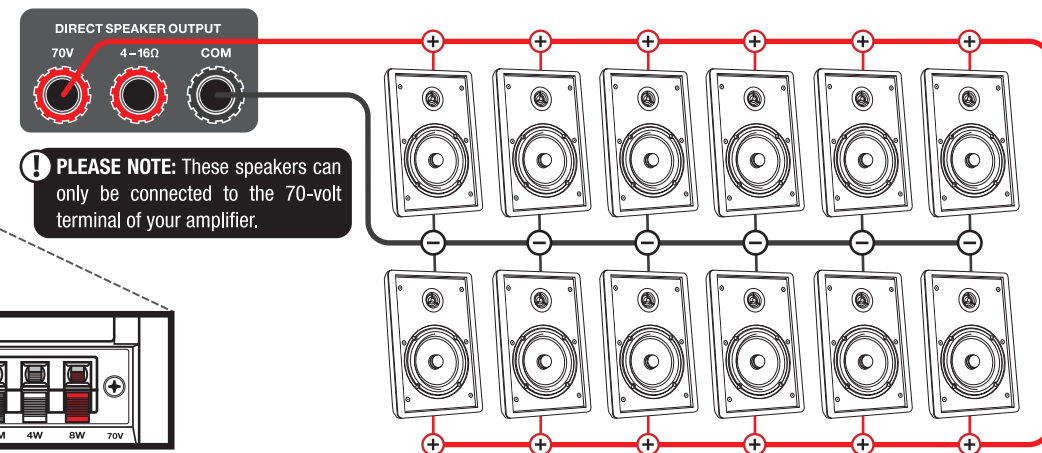

MOUNTING

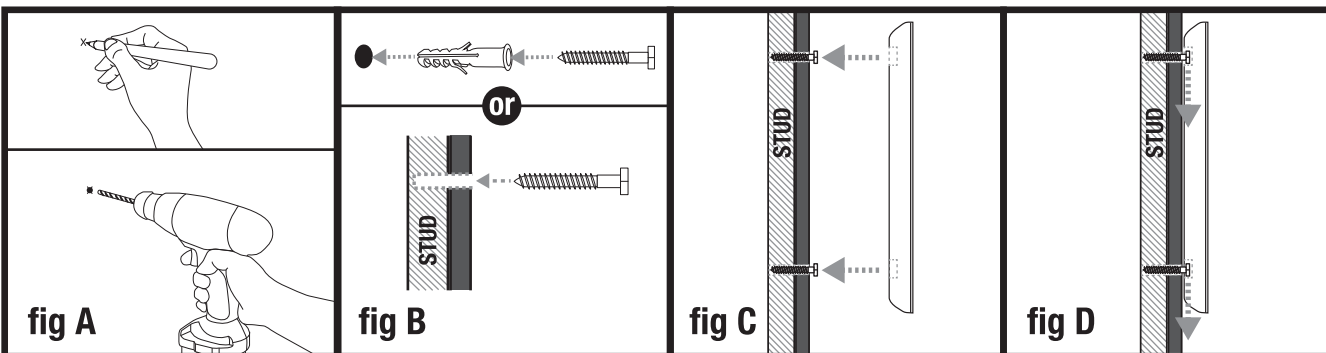

To mount the ROCK SLIM 70 speaker, make marks on the wall where you wish to mount the speaker. Using a drill, make holes where you made your marks (fig A). We recommend using wall anchors (fig B; not included) or drilling into a stud. If you are using anchors, make sure the holes are deep enough to accommodate them. Once the mounting screws (not included) are in place simply lift the speaker, align the screws with the mounting holes and slide onto the screws (fig C). Now tug the speaker down slightly to ensure that it is seated properly (fig D). Repeat these steps for your other speakers.

CARE AND MAINTENANCE

Make sure to turn all equipment off before cleaning. The cabinet only needs occasional dusting. Please do not touch the drive units. Do not attempt to clean the speakers with chemical solvents as this may damage the paint surface. Clean with a dry cloth.